

\$7.00
\$2.00

1997 2 28 2000

KENT COUNTY REMONUMENTATION

SECTION

LAND CORNER RECORDATION CERTIFICATE Filing Requirement of Act 74, Mich. P.A. 1970

STATE OF MICHIGAN
COUNTY OF KENT
RECEIVED FOR RECORD
1999 MAR 24 AM 8:02

REG. OF DEEDS

11168

Register of Deeds Stamp & File Number

For corners in

KENT COUNTY (County)	Located In:	Corner Code #
1. Public Land Survey	T <u>10N</u> R <u>12W</u>	Tyrone Twp. H-7
	T ___ R ___	_____
	T ___ R ___	_____
	T ___ R ___	_____
2. Property Controlling in Section	S ___ T ___ R ___	_____
	S ___ T ___ R ___	_____
3. Miscellaneous Property in Sec.	S ___ T ___ R ___	_____
	S ___ T ___ R ___	_____

4. Lot No. _____, Recorded Plat _____
5. Private Claims _____

I, Kirk Breitels, in a field survey on Jan. 25, 19 99 do hereby state that under requirements of P.A. 74, Michigan P.A. of 1970, the corner points mentioned in lines 1 and 2 above were in conformance with regulations and rules therefore as required in the current manual of survey instructions of the United States Department of the Interior, Bureau of Land Management or by a decree of a Court of Law and /or that the corner points mentioned in lines 3, 4 and 5 above were in conformance with the rules of the Michigan Board of Land Surveyors or by a Decree of a Court of Law; established, re-established, monumented, recovered, found as expressed below:

NOTE: Not more than 2 corners, all in the same town and range, may be recorded on this certificate.

	A	B	C	D	E	F	G	H	I	J	K	L	M
1													
2	6	5	4	3	2	1							
3													
4	7	8	9	10	11	12							
5													
6	18	17	16	15	14	13							
7													
8	19	20	21	22	23	24							
9													
10	30	29	28	27	26	25							
11													
12	31	32	33	34	35	36							
13													

A. Description of original monument and accessories and/or subsequent restoration:

H-7 1837	GLO	Whitcomb	Set Post
1934	Kent Co. Wits		1 1/2" Iron
1976	LCRC #902	McCloskey	1" Iron
1983	LCRC #3428	Bueche	Set Kent County Monument
1991	LCRC #5998	Byl	Kent County Monument

P.A. 345 1990 KENT COUNTY
PEER APPROVED 2/25/99
CHAIRMAN Kirk Breitels

The position of this corner was previously approved by the Kent County Remonumentation Peer Group, monumented by John C. Bueche on 5-18-83 and was recorded per LCRC #3428.

B. Description of corner evidence found and/or method applied in restoring or reestablishing corner:

H-7 Found Kent County Monument (Harrison) per witnesses from above LCRC as set by John C. Bueche in place of the Capped Rod (MVK) he found. Said Capped Rod checks with Kent Co. Wits. and LCRC #902.

LCRC #3428	Nail & Remon. tag 30" Maple S80°W 143.62'	LCRC #5998	Nail & Remon. tag 30" Maple S80°W 143.58'
	PK Nail P. Pole S35°E 113.13'		PK Nail P. Pole S35°E 113.03'
	Nail & Remon. tag dbl. 4" Cherry 83.67'		PK Nail P. Pole S25°W 100.60'
	PK Nail P. Pole S25°W 100.60'		NW cor. house foundation S30°E 205.52'
	NW cor. house foundation S30°E 205.52'		Nail & Remon. tag P. Pole N80°W 120.42'

On C/L gravel N-S & E-W
The selected location is accepted by me and is generally accepted by professional surveyors as the best available evidence of the position of the original corner.

C. Description of monument for corner and accessories established to perpetuate locating the position of the corner:

H-7 Standard Kent County Monument	
Nail & KC Remon. tag S. side 32" Maple	S80°W 143.58'
PK Nail NE side Power Pole	S35°E 113.13'
PK Nail E. side Power Pole	S25°W 100.60'
NW corner house foundation (addition)	S30°E 184.24'
Nail & KC Remon. tag S. side Power Pole	N80°W 120.42'
Nail & KC Remon. tag W. side Power Pole	N20°E 220.35'
On C/L gravel road N-S & E-W ±	

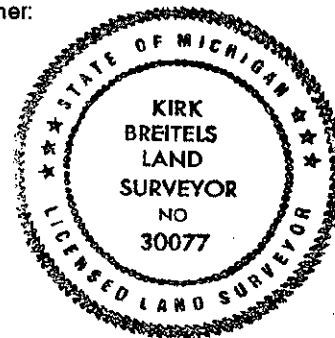

Signed by Kirk Breitels
Surveyor's Michigan License No. 30077

Date 2/25/99