

JAY 22 2000

KENT COUNTY REMONUMENTATION

\$7.00
\$2.00

SECTION

LAND CORNER RECORDATION CERTIFICATE
Filing Requirement of Act 74, Mich. P.A. 1970

For corners in

KENT COUNTY (County)	Located In:	Corner Code #
	Tyrone Twp.	H-9
1. Public Land Survey	T 10N R 12W	
	T ___ R ___	
	T ___ R ___	
	T ___ R ___	
2. Property Controlling in Section	S ___ T ___ R ___	
	S ___ T ___ R ___	
3. Miscellaneous Property in Sec.	S ___ T ___ R ___	
	S ___ T ___ R ___	

STATE OF MICHIGAN
COUNTY OF KENT
RECEIVED FOR RECORD

1999 MAR 24 AM 9:32

REG. OF DEEDS

11169
Register of Deeds Stamp & File Number

4. Lot No. _____, Recorded Plat _____
5. Private Claims _____

I, Kirk Breitels, in a field survey on Jan. 19, 19 99 do hereby state that under requirements of P.A. 74, Michigan P.A. of 1970, the corner points mentioned in lines 1 and 2 above were in conformance with regulations and rules therefore as required in the current manual of survey instructions of the United States Department of the Interior, Bureau of Land Management or by a decree of a Court of Law and /or that the corner points mentioned in lines 3, 4 and 5 above were in conformance with the rules of the Michigan Board of Land Surveyors or by a Decree of a Court of Law; established, re-established, monumented, recovered, found as expressed below:

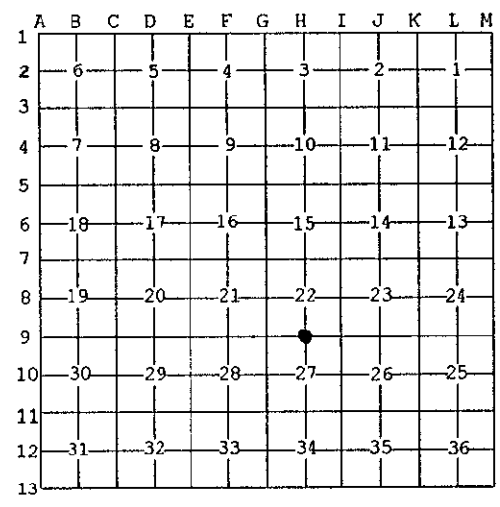

NOTE: Not more than 2 corners, all in the same town and range, may be recorded on this certificate.

A. Description of original monument and accessories and/or subsequent restoration:

Date	Monument	Accessories	Restoration
H-9 1837	GLO	Whitcomb	Set Post
1966	Kent Co. Wits		Iron on Stone
1981	LCRC #1956	Bonnema	1/2" Iron
1982	LCRC #3026	Starr	Set Kent County Monument
1991	LCRC #5999	Byl	Kent County Monument

P.A. 345 1990 KENT COUNTY
PEER APPROVED 2/25/99
CHAIRMAN Thomas C. Starr

The position of this corner was previously approved by the Kent County Remonumentation Peer Group, monumented by Thomas C. Starr on 8-2-82 and was recorded per LCRC #3026.

B. Description of corner evidence found and/or method applied in restoring or reestablishing corner:

H-9 Found Kent County Monument (Harrison) per witnesses from above LCRC as set by Thomas C. Starr in place of the 1/2" Iron Pipe over a Stone he found. Said Iron & Stone check with Kent Co. Wits. and LCRC #1956.

LCRC #3026	LCRC #5999
Nail & Remon. tag 32" Maple S25°W 87.67'	Nail & Remon. tag 40" Maple S25°W 87.25'
Nail & Remon. tag P & T Pole S40°E 88.24'	Nail & Remon. tag P & T Pole S40°E 88.24'
Nail & Remon. tag P & T Pole N45°E 76.84'	Nail & Remon. tag P & T Pole N45°E 76.84'
Nail & Remon. tag Tri. 12" Ash N20°E 88.92'	Nail & Remon. tag Tri. 12" Ash N20°E 88.85'
Nail & Remon. tag P & T Pole N60°W 131.34'	Nail & Remon. tag P & T Pole N60°W 131.30'
NW cor. frame house S60°W 141.08'	NW cor. frame house S60°W 141.02'

The selected location is accepted by me and is generally accepted by professional surveyors as the best available evidence of the position of the original corner.

C. Description of monument for corner and accessories established to perpetuate locating the position of the corner:

H-9 Standard Kent County Monument

Nail & KC Remon. tag W. side 40" Maple	S25°W	87.22'
Nail & KC Remon. tag W. side P. Pole	S40°E	88.24'
Nail & KC Remon. tag W. side P. Pole	N45°E	76.86'
Nail & KC Remon. tag W. side Tri. 16" Ash	N20°E	88.73'
Nail & KC Remon. tag S. side P. Pole	N60°W	131.30'

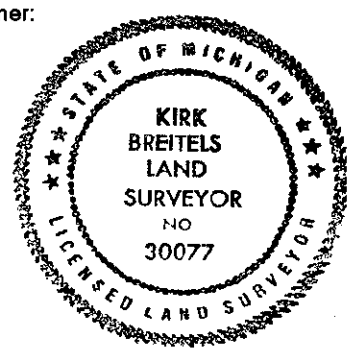

Signed by Kirk Breitels
Surveyor's Michigan License No. 30077

Date 2/25/99