

\$7.00
\$2.00

MAY 22 2000

SECTION

KENT COUNTY REMONUMENTATION

LAND CORNER RECORDATION CERTIFICATE Filing Requirement of Act 74, Mich. P.A. 1970

For corners in
KENT COUNTY
(County)

Located In:	Corner Code #
T 10N R 12W T ___ R ___ T ___ R ___ T ___ R ___ T ___ R ___	Tyrone Twp. I-4 _____ _____ _____ _____ _____
S ___ T ___ R ___ S ___ T ___ R ___ S ___ T ___ R ___ S ___ T ___ R ___	_____ _____ _____ _____

- 1. Public Land Survey
- 2. Property Controlling in Section
- 3. Miscellaneous Property in Sec.

STATE OF MICHIGAN
COUNTY OF KENT
RECEIVED FOR RECORD

1999 MAR 24 AM 8:02

REG. OF DEEDS

11172

Register of Deeds Stamp & File Number

4. Lot No. _____, Recorded Plat _____
5. Private Claims _____

	A	B	C	D	E	F	G	H	I	J	K	L	M
1													
2	6		5		4		3		2		1		
3													
4	7		8		9		10		11		12		
5													
6	18		17		16		15		14		13		
7													
8	19		20		21		22		23		24		
9													
10	30		29		28		27		26		25		
11													
12	31		32		33		34		35		36		
13													

I, Kirk Breitels, in a field survey on Jan. 22, 1999 do hereby state that under requirements of P.A. 74, Michigan P.A. of 1970, the corner points mentioned in lines 1 and 2 above were in conformance with regulations and rules therefore as required in the current manual of survey instructions of the United States Department of the Interior, Bureau of Land Management or by a decree of a Court of Law and/or that the corner points mentioned in lines 3, 4 and 5 above were in conformance with the rules of the Michigan Board of Land Surveyors or by a Decree of a Court of Law; established, re-established, monumented, recovered, found as expressed below:

NOTE: Not more than 2 corners, all in the same town and range, may be recorded on this certificate.

A. Description of original monument and accessories and/or subsequent restoration:

I-4	1837	GLO	Whitcomb	Set Post
	1966	Kent Co. Wits		Concrete Monument
	1975	LCRC #824	Bonnema	Concrete Monument
	1982	LCRC #3028	Starr	Set Kent County Monument
	1991	LCRC #6005	Byl	Kent County Monument

P.A. 345 1990 KENT COUNTY
PEER APPROVED 2/25/99
CHAIRMAN [Signature]

The position of this corner was previously approved by the Kent County Remonumentation Peer Group, monumented by Thomas C. Starr on 7-5-82 and was recorded per LCRC #.3028.

B. Description of corner evidence found and/or method applied in restoring or reestablishing corner:

I-4	Found Kent County Monument (Harrison) per witnesses from above LCRC as set by Thomas C. Starr in place of the 1/2" Rebar over a 3/4" Iron Pipe over a Concrete Monument he found. All check with Kent Co. Wits. and LCRC #824.		
	LCRC #3028		
	LCRC #6005		
Nail & Remon. tag Tel. Pole	West 35.26'	Nail & Remon. tag Te. Pole	S90°W 35.28'
Nail & Remon. tag 28" Oak	N10°W 51.06'	Nail & Remon. tag 12" Cherry	N25°E 70.33'
Nail & Remon. tag 12" Cherry	N25°E 70.20'	Nail & Remon. tag 14" Cherry	S85°E 46.17'
Nail & Remon. tag 12" Cherry	S85°E 46.17'	SE corner frame house foundation	N50°W 93.15'
SE corner frame house	N50°W 92.78'	USGS BM	S70°W 27.25'
USGS BM	S70°W 27.20'		

The selected location is accepted by me and is generally accepted by professional surveyors as the best available evidence of the position of the original corner.

C. Description of monument for corner and accessories established to perpetuate locating the position of the corner:

I-4 Standard Kent County Monument	
Nail & KC Remon. tag S. side Tel. Pole	S90°W 35.26'
Nail & KC Remon. tag W. side 12" Cherry	N25°E 70.33'
Nail & KC Remon. tag S. side 14" Cherry	S85°E 46.17'
USGS Benchmark	S70°W 27.25'
Nail & KC Remon. tag SW side 27" Oak	N40°W 86.51'
3' West of C/L gravel road N-S	

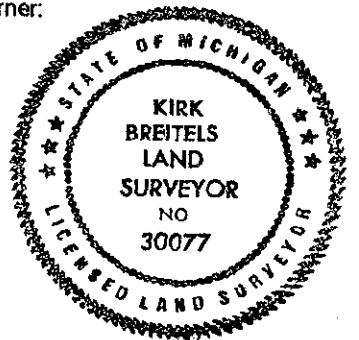

Signed by [Signature]
Surveyor's Michigan License No. 30077

Date 2/25/99