

MAY 22 2000

KENT COUNTY REMONUMENTATION

SECTION

LAND CORNER RECORDATION CERTIFICATE
Filing Requirement of Act 74, Mich. P.A. 1970

For corners in

KENT COUNTY

(County)

Located in:

Corner Code #

Tyrone Twp.

1. Public Land Survey

T 10NR 12W

I-6

T R

T R

T R

T R

2. Property Controlling in Section

S T R

S T R

3. Miscellaneous Property in Sec.

S T R

S T R

REG. OF DEEDS

STATE OF MICHIGAN
COUNTY OF KENT
RECEIVED FOR RECORD
1999 JUL -9 AM 11:20

11258

Register of Deeds Stamp & File Number

4. Lot No. _____, Recorded Plat _____

5. Private Claims _____

I, Kirk Breitels, in a field survey on May 26, 19 99 do hereby state that under requirements of P.A. 74, Michigan P.A. of 1970, the corner points mentioned in lines 1 and 2 above were in conformance with regulations and rules therefore as required in the current manual of survey instructions of the United States Department of the Interior, Bureau of Land Management or by a decree of a Court of Law and/or that the corner points mentioned in lines 3, 4 and 5 above were in conformance with the rules of the Michigan Board of Land Surveyors or by a Decree of a Court of Law; established, re-established, monumented, recovered, found as expressed below:

NOTE: Not more than 2 corners, all in the same town and range, may be recorded on this certificate.

A	B	C	D	E	F	G	H	I	J	K	L	M
1												
2	6	5	4	3	2	1						
3												
4	7	8	9	10	11	12						
5												
6	18	17	16	15	14	13						
7												
8	19	20	21	22	23	24						
9												
10	30	29	28	27	26	25						
11												
12	31	32	33	34	35	36						
13												

A. Description of original monument and accessories and/or subsequent restoration:

I-6	1837	GLO	Whitcomb	Set Post
	1899	Williams & Works		Stake & Iron
	1941	Kent Co. Wits		1" Iron
	1983	LCRC #3685	Bueche	Set Kent County Monument
	1991	LCRC #6007	Byl	Reset Kent County Monument

P.A. 345 1990 KENT COUNTY
PEER APPROVED 6/24/99
CHAIRMAN Harry Huber

The position of this corner was previously approved by the Kent County Remonumentation Peer Group, monumented by John C. Bueche on 12-6-83 and was recorded per LCRC #3685.

B. Description of corner evidence found and/or method applied in restoring or reestablishing corner:

I-6 Found Kent Co. Mon. (Harrison) - LEANING WESTERLY - per wits. from above LCRC as set by John C. Bueche in place of the Capped N & J Iron he found. Said Iron checks with Kent Co. Wits. and Williams & Works measurements.

LCRC #3685	Nail & Remon. tag P. Pole	N20°W 93.20'
	Nail & Remon. tag 8" Poplar	N45°E 57.60'
	Nail & tag 12" Cherry	S80°E 50.37'
	Nail & tag 12" Basswood	S40°E 56.77'
	C/L blacktop road N-S is East 9.5' ±	
LCRC #6007	Nail & Remon. tag P. Pole	N20°W 93.13'
	Nail & Remon. tag 10" Poplar	N45°E 57.60'
	Nail & Remon. tag 14" Cherry	S80°E 50.37'
	Nail & Remon. tag 14" Basswood	S40°E 56.77'
	Nail & Remon. tag 14" Cherry	S50°E 47.90'
	C/L gravel road N-S is East 9.5' ±	

The selected location is accepted by me and is generally accepted by professional surveyors as the best available evidence of the position of the original corner.

C. Description of monument for corner and accessories established to perpetuate locating the position of the corner:

I-6 Removed and Reset Standard Kent County Monument

Nail & KC Remon. tag W. side P. Pole	N20°W 93.11'
Nail & KC Remon. tag SE side 12" Poplar	N45°E 57.60'
Nail & KC Remon. tag S. side 16" Cherry	S80°E 50.41'
Nail & KC Remon. tag N. side 16" Basswood	S40°E 56.77'
Nail & KC Remon. tag SW side 16" Cherry	S50°E 47.98'
C/L N-S gravel road is East 9.5' ±	

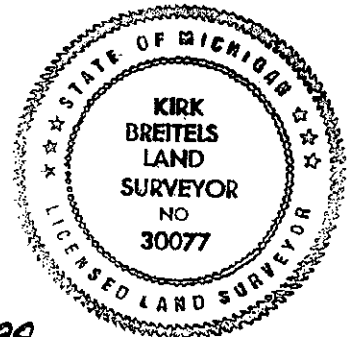

Signed by Kirk Breitels
Surveyor's Michigan License No. 30077

Date 6/24/99