

KENT COUNTY REMONUMENTATION

LAND CORNER RECORDATION CERTIFICATE  
Filing Requirement of Act 74, Mich. P.A. 1970

REG. OF DEEDS

STATE OF MICHIGAN  
COUNTY OF KENT  
RECEIVED FOR RECORD  
1999 NOV -4 AM 8:37

37.00  
32.00

MAY 22 2399

SECTION

For corners in

KENT COUNTY (County)	Located In:	Corner Code #
	T10N R 12W	Tyrone Twp. J-4
1. Public Land Survey	T___ R___	_____
	T___ R___	_____
	T___ R___	_____
2. Property Controlling in Section	S___ T___ R___	_____
	S___ T___ R___	_____
3. Miscellaneous Property in Sec.	S___ T___ R___	_____
	S___ T___ R___	_____

11503

Register of Deeds Stamp & File Number

4. Lot No. \_\_\_\_\_, Recorded Plat \_\_\_\_\_  
5. Private Claims \_\_\_\_\_

I, Kirk Breitels, in a field survey on Sept. 13, 19 99 do hereby state that under requirements of P.A. 74, Michigan P.A. of 1970, the corner points mentioned in lines 1 and 2 above were in conformance with regulations and rules therefore as required in the current manual of survey instructions of the United States Department of the Interior, Bureau of Land Management or by a decree of a Court of Law and /or that the corner points mentioned in lines 3, 4 and 5 above were in conformance with the rules of the Michigan Board of Land Surveyors or by a Decree of a Court of Law; established, re-established, monumented, recovered, found as expressed below:

NOTE: Not more than 2 corners, all in the same town and range, may be recorded on this certificate.

	A	B	C	D	E	F	G	H	I	J	K	L	M
1													
2	6		5		4		3		2		1		
3													
4	7		8		9		10		11		12		
5													
6	18		17		16		15		14		13		
7													
8	19		20		21		22		23		24		
9													
10	30		29		28		27		26		25		
11													
12	31		32		33		34		35		36		
13													

A. Description of original monument and accessories and/or subsequent restoration:

J-4 1837 GLO Williams & Works Kent Co. Wits  
Not Set  
No information  
No information

P.A. 345 1990 KENT COUNTY  
PEER APPROVED 9/23/99  
CHAIRMAN *[Signature]*

B. Description of corner evidence found and/or method applied in restoring or reestablishing corner:

J-4 All of the Section except a small parcel in the NE corner is owned by the Michigan Dept. of Natural Resources.

Peer group decided to hold Intersection of 1/4 lines and but not to set a monument

The Intersection of 1/4 lines is accepted by me and is generally accepted by professional surveyors as the best available evidence of the position of the corner.

C. Description of monument for corner and accessories established to perpetuate locating the position of the corner:

J-4 NO MONUMENT SET AT THIS CORNER

N 1/4 corner: N 00°14'47" E 2684.10'  
E 1/4 corner: S 89°34'57" E 2649.53'  
S 1/4 corner: S 00°14'47" W 2670.26'  
W 1/4 corner: N 89°34'57" W 2650.86'

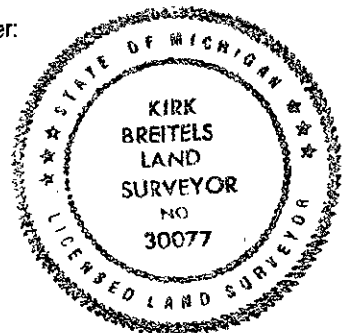

Signed by *[Signature]*  
Surveyor's Michigan License No. 30077

Date 10/28/99