

KENT COUNTY REMONUMENTATION

LAND CORNER RECORDATION CERTIFICATE  
Filing Requirement of Act 74, Mich. P.A. 1970

SECTION \_\_\_\_\_

For corners in

<u>KENT COUNTY</u> (County)	Located In:	Corner Code #
	Tyrone Twp.	
1. Public Land Survey	T <u>10</u> N R <u>12</u> W	<u>J-7</u>
	T _____ R _____	_____
	T _____ R _____	_____
	T _____ R _____	_____
2. Property Controlling in Section	S _____ T _____ R _____	_____
	S _____ T _____ R _____	_____
3. Miscellaneous Property in Sec.	S _____ T _____ R _____	_____
	S _____ T _____ R _____	_____

REG. OF DEEDS

*[Signature]*

STATE OF MICHIGAN  
COUNTY OF KENT  
RECEIVED FOR RECORD  
1999 MAR 24 AM 9:03

11181

Register of Deeds Stamp & File Number

4. Lot No. \_\_\_\_\_, Recorded Plat \_\_\_\_\_  
5. Private Claims \_\_\_\_\_

I, Kirk Breitels, in a field survey on Feb. 18, 19 99 do hereby state that under requirements of P.A. 74, Michigan P.A. of 1970, the corner points mentioned in lines 1 and 2 above were in conformance with regulations and rules therefore as required in the current manual of survey instructions of the United States Department of the Interior, Bureau of Land Management or by a decree of a Court of Law and/or that the corner points mentioned in lines 3, 4 and 5 above were in conformance with the rules of the Michigan Board of Land Surveyors or by a Decree of a Court of Law; established, re-established, monumented, recovered, found as expressed below:

A	B	C	D	E	F	G	H	I	J	K	L	M
1												
2	6		5		4		3		2		1	
3												
4	7		8		9		10		11		12	
5												
6	10		17		16		15		14		13	
7												
8	19		20		21		22		23		24	
9												
10	30		29		28		27		26		25	
11												
12	31		32		33		34		35		36	
13												

NOTE: Not more than 2 corners, all in the same town and range, may be recorded on this certificate.

A. Description of original monument and accessories and/or subsequent restoration:

J-7	1837	GLO	Whitcomb	Set Post
		Kent Co. Wits		No information
	1981	LCRC #1624	E. Glaza	1/2" Rerod
	1982	LCRC #3020	Starr	Set Kent County Monument
	1991	LCRC #6017	Byl	Kent County Monument

P.A. 345 1990 KENT COUNTY  
PEER APPROVED 2/25/99  
CHAIRMAN [Signature]

The position of this corner was previously approved by the Kent County Remonumentation Peer Group, monumented by Thomas C. Starr on 8-2-82 and was recorded per LCRC #3020.

B. Description of corner evidence found and/or method applied in restoring or reestablishing corner:

J-7 Found Kent County Monument (Harrison) per witnesses from above LCRC as set by Thomas C. Starr in place of the 1/2" Rerod he found. Said Rerod checks with LCRC #1624.

LCRC #3020	Nail & Remon. tag 10" Maple North 20.55'	LCRC #6017	Nail & Remon. tag 12" Maple N00°E 20.50'
	Nail & Remon. tag 12" Poplar East 19.93'		Nail & Remon. tag 12" Poplar N90°E 19.93'
	Nail & Remon. tag 12" Maple S25°E 35.64'		Nail & Remon. tag 14" Maple S25°E 35.59'
	Nail & Remon. tag 18" Oak S20°W 22.06'		Nail & Remon. tag 24" Oak S20°W 22.03'
	Nail & Remon. tag 8" Maple S70°W 18.19'		Nail & Remon. tag 10" Maple S70°W 18.19'
	Nail & Remon. tag 18" Oak N80°W 28.37'		Nail & Remon. tag 18" Oak N80°W 28.33'

The selected location is accepted by me and is generally accepted by professional surveyors as the best available evidence of the position of the original corner.

C. Description of monument for corner and accessories established to perpetuate locating the position of the corner:

J-7 Standard Kent County Monument

Nail & KC Remon. tag E. side 14" Maple	N00°E	20.47'
Nail & KC Remon. tag N. side 12" Poplar	N90°E	19.93'
Nail & KC Remon. tag W. side 18" Maple	S25°E	35.56'
Nail & KC Remon. tag W. side 26" Oak	S20°W	22.05'
Nail & KC Remon. tag S. side 12" Maple	S70°W	18.09'
Nail & KC Remon. tag N. side 18" Oak	N80°W	27.63' (tree is leaning)
Nail & KC Remon. tag NE side 16" Oak	N35°W	67.80'

On remains of E-W fence ±

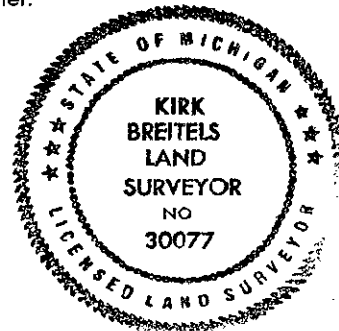

Signed by [Signature]  
Surveyor's Michigan License No. 30077

Date 2/25/99