

MAY 22 2000

\$7.00
\$2.00

SECTION

KENT COUNTY REMONUMENTATION

LAND CORNER RECORDATION CERTIFICATE Filing Requirement of Act 74, Mich. P.A. 1970

REG. OF DEEDS

[Signature]

STATE OF MICHIGAN
COUNTY OF KENT
RECEIVED FOR RECORD
1999 NOV -4 AM 8:37

For corners in
KENT COUNTY
(County)

Located In:	Corner Code #
T 10N R 12W	Tyrone Twp. K-1
T R	
T R	
T R	
S T R	
S T R	
S T R	
S T R	

1. Public Land Survey

2. Property Controlling in Section

3. Miscellaneous Property in Sec.

4. Lot No. _____, Recorded Plat _____
5. Private Claims _____

11506
Register of Deeds Stamp & File Number

I, Kirk Breitel, in a field survey on Sept. 23, 1999 do hereby state that under requirements of P.A. 74, Michigan P.A. of 1970, the corner points mentioned in lines 1 and 2 above were in conformance with regulations and rules therefore as required in the current manual of survey instructions of the United States Department of the Interior, Bureau of Land Management or by a decree of a Court of Law and/or that the corner points mentioned in lines 3, 4 and 5 above were in conformance with the rules of the Michigan Board of Land Surveyors or by a Decree of a Court of Law; established, re-established, monumented, recovered, found as expressed below:

NOTE: Not more than 2 corners, all in the same town and range, may be recorded on this certificate.

	A	B	C	D	E	F	G	H	I	J	K	L	M
1													
2	6		5			4		3		2		1	
3													
4	7		8			9		10		11		12	
5													
6	18		17			16		15		14		13	
7													
8	19		20			21		22		23		24	
9													
10	30		29			28		27		26		25	
11													
12	31		32			33		34		35		36	
13													

A. Description of original monument and accessories and/or subsequent restoration:

K-1	1837	GLO	Brookfield	Set Post
		Kent Co. Wits		1/2" Iron
	1973	LCRC #375	Bonnema	1/2" Iron
	1985	LCRC #4377	Ochs	Set Kent County Monument on Twp. Line
	1991	LCRC #6021	Byl	Kent County Monument

P.A. 345 1990 KENT COUNTY
PEER APPROVED 9/23/99
CHAIRMAN [Signature]

The position of this corner was previously approved by the Kent County Remonumentation Peer Group, monumented by Norman L. Ochs on 10-23-85 and was recorded per LCRC #4377.

B. Description of corner evidence found and/or method applied in restoring or reestablishing corner:

K-1 Found Kent County Monument (Harrison) per witnesses from above LCRC as set on Twp. Line by Norman L. Ochs in place of the 1/2" Rod he found. Said 1/2" Rod checks with Kent Co. Wits. and LCRC #375.

LCRC #4377		LCRC #6021	
Nail in 14" Poplar	South 88.67'	Nail & Remon. tag 6" Elm	N70°W 64.25'
Nail in Fence Post	N70°W 68.67'	Nail & Remon. tag 8" Poplar	N05°E 20.84'
Spike in 5" Elm	S40°E 57.68'	Nail & Remon. tag P. Pole	S60°E 107.13'
Spike in 4" Elm	N70°W 64.28'	Nail & Remon. tag 10" Poplar	S35°W 54.83'
		SE cor. hse. fnd. N60°W 132.55'	SW cor. conc. N55°E 122.00'
		Cast Iron Mon. (S 1/4 cor. Sec. 36-11-12)	N90°E 288.97'

The selected location is accepted by me and is generally accepted by professional surveyors as the best available evidence of the position of the original corner.

C. Description of monument for corner and accessories established to perpetuate locating the position of the corner:

K-1 Standard Kent County Monument	
Nail & KC Remon. tag S. side 6" dead Elm	N70°W 64.30'
Nail & KC Remon. tag W. side 12" Poplar	N05°E 20.82'
Nail & KC Remon. tag N. side P. Pole	S60°E 107.13'
Nail & KC Remon. tag E. side 15" Poplar	S35°W 54.83'
SE corner house foundation	N60°W 132.55'
SW corner mobile home conc. slab	N55°E 122.00'
S 1/4 cor. Sec. 36-11-12 (Newaygo Co. Mon.)	East 289.02'

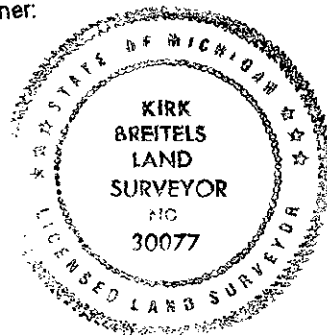

Signed by [Signature]
Surveyor's Michigan License No. 30077

Date 10/28/99