

57.00
\$2.00

MAY 28 2000

KENT COUNTY REMONUMENTATION

SECTION

LAND CORNER RECORDATION CERTIFICATE Filing Requirement of Act 74, Mich. P.A. 1970

For corners in

<u>KENT COUNTY</u> (County)	Located In:	Corner Code #
1. Public Land Survey	T <u>10N</u> R <u>12W</u>	Tyrone Twp. L-4
	T ___ R ___	_____
	T ___ R ___	_____
	T ___ R ___	_____
2. Property Controlling in Section	S ___ T ___ R ___	_____
	S ___ T ___ R ___	_____
3. Miscellaneous Property in Sec.	S ___ T ___ R ___	_____
	S ___ T ___ R ___	_____

REG. OF DEEDS

[Signature]

STATE OF MICHIGAN
COUNTY OF KENT
RECEIVED FOR RECORD
1999 NOV - 4 AM 8:37

11508

Register of Deeds Stamp & File Number

4. Lot No. _____, Recorded Plat _____
5. Private Claims _____

I, Kirk Breitels, in a field survey on Aug. 12, 1999 do hereby state that under requirements of P.A. 74, Michigan P.A. of 1970, the corner points mentioned in lines 1 and 2 above were in conformance with regulations and rules therefore as required in the current manual of survey instructions of the United States Department of the Interior, Bureau of Land Management or by a decree of a Court of Law and /or that the corner points mentioned in lines 3, 4 and 5 above were in conformance with the rules of the Michigan Board of Land Surveyors or by a Decree of a Court of Law; established, re-established, monumented, recovered, found as expressed below:

NOTE: Not more than 2 corners, all in the same town and range, may be recorded on this certificate.

	A	B	C	D	E	F	G	H	I	J	K	L	M
1													
2		6		5		4		3		2		1	
3													
4		7		8		9		10		11		12	
5													
6		18		17		16		15		14		13	
7													
8		19		20		21		22		23		24	
9													
10		30		29		28		27		26		25	
11													
12		31		32		33		34		35		36	
13													

A. Description of original monument and accessories and/or subsequent restoration:

L-4	1837	GLO	Not Set
	1915	Williams & Works	Set C 1/4 corner 2640' N. of S 1/4 cor. and 2670 W. of E 1/4 cor.
		Kent Co. Wits	No information

P.A. 345 1990 KENT COUNTY
PEER APPROVED 8/26/99
CHAIRMAN *[Signature]*

B. Description of corner evidence found and/or method applied in restoring or reestablishing corner:

L-4 Found Capped Rerod (Hackbardt). Said Rerod is 0.1' S. & less than 0.1' W. from interseciton of 1/4 lines.

Fits measurement of 1915 Williams & Works information to S 1/4 corner.

The Capped Rerod (Hackbardt) is accepted by me and is generally accepted by professional surveyors as the best available evidence of the position of the corner.

C. Description of monument for corner and accessories established to perpetuate locating the position of the corner:

L-4 Set Standard Kent County Monument in place of the Capped Rerod (Hackbardt)

- Nail & KC Remon. tag NW side 18" Oak N45°E 36.01'
- Nail & KC Remon. tag E. side 10" Poplar N00°W 27.18'
- Nail & KC Remon. tag S. side 12" Poplar S70°W 25.58'
- Nail & KC Remon. tag SE side 12" Poplar S25°W 6.18'
- Nail & KC Remon. tag W. side 12" Poplar S05°E 19.04'
- C/L E-W foot path is North 55' ±

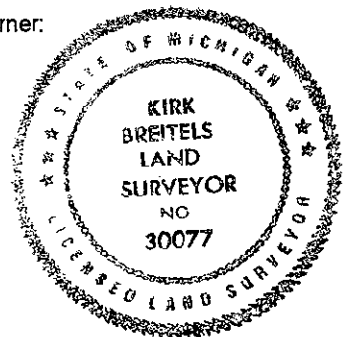

Signed by *[Signature]*
Surveyor's Michigan License No. 30077

Date 10/20/99