

\$7.00
\$2.00 SECTION

KENT COUNTY REMONUMENTATION

LAND CORNER RECORDATION CERTIFICATE
Filing Requirement of Act 74, Mich. P.A. 1970

For corners in

KENT COUNTY
(County)

Located In:	Corner Code #
T10N R12W	Tyrone Twp.
T R	L-7
T R	
T R	
S T R	
S T R	
S T R	
S T R	

1. Public Land Survey

2. Property Controlling in Section

3. Miscellaneous Property in Sec.

4. Lot No. _____, Recorded Plat _____
5. Private Claims _____

I, Kirk Breitels, in a field survey on Feb. 18, 19 99 do hereby state that under requirements of P.A. 74, Michigan P.A. of 1970, the corner points mentioned in lines 1 and 2 above were in conformance with regulations and rules therefore as required in the current manual of survey instructions of the United States Department of the Interior, Bureau of Land Management or by a decree of a Court of Law and/or that the corner points mentioned in lines 3, 4 and 5 above were in conformance with the rules of the Michigan Board of Land Surveyors or by a Decree of a Court of Law; established, re-established, monumented, recovered, found as expressed below:

NOTE: Not more than 2 corners, all in the same town and range, may be recorded on this certificate.

A. Description of original monument and accessories and/or subsequent restoration:

L-7 1837	GLO	Whitcomb	Set Post
1954	Williams & Works		Iron
1960	Kent Co. Wits		Iron
1984	LCRC #4019	Bueche	Set Kent County Monument
1991	LCRC #6034	Byl	Kent County Monument

P.A. 345 1990 KENT COUNTY
PEER APPROVED 2/25/99
CHAIRMAN Hauptfuehr

The position of this corner was previously approved by the Kent County Remonumentation Peer Group, monumented by John C. Bueche on 11-7-84 and was recorded per LCRC #4019.

B. Description of corner evidence found and/or method applied in restoring or reestablishing corner:

L-7 Found Kent County Monument (Harrison) per witnesses from above LCRC as set by John C. Bueche in place of the Iron he found. Said Iron checks with Williams & Works information and Kent Co. Wit.

LCRC #4019	LCRC #6034
Nail-tag 12" Pine N30°W 53.51'	Nail-tag 12" Pine N30°W 53.49'
Nail-tag 14" Pine N30°E 52.96'	Nail-tag 16" Pine N30°E 52.96'
Nail-tag 16" Pine N55°E 94.58'	Nail-tag 18" Pine N55°E 94.58'
Nail-tag 28" Oak S70°E 70.47'	Nail-tag 30" Oak S70°E 70.45'
Nail-tag 24" Oak S15°E 37.22'	Nail-tag 26" Oak S15°E 37.24'
Nail-tag 34" Oak S40°W 58.12'	Nail-tag 34" Oak S40°W 58.12'

The selected location is accepted by me and is generally accepted by professional surveyors as the best available evidence of the position of the original corner.

C. Description of monument for corner and accessories established to perpetuate locating the position of the corner:

L-7 Standard Kent County Monument	
Nail & KC Remont. tag W. side 12" Pine	N30°W 53.49'
Nail & KC Remon. tag W. side 18" Pine	N30°E 52.99'
Nail & KC Remon. tag W. side 20" Pine	N55°E 94.55'
Nail & KC Remon. tag S. side 32" Oak	S70°E 70.42'
Nail & KC Remon. tag W. side 26" Oak	S15°E 37.22'
Nail & KC Remon. tag W. side 34" Oak	S40°W 58.12'
Nail & KC Remon. tag N. side 24" Oak	N80°W 73.48'

C/L 2 track N-S is West 60' ±
S. side Pines is North 40' ±

Signed by Kirk Breitels
Surveyor's Michigan License No. 30077

Date 2/25/99

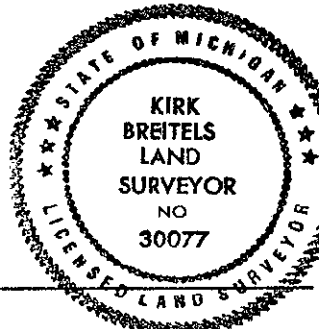

STATE OF MICHIGAN
COUNTY OF KENT
RECEIVED FOR RECORD
1999 MAR 24 AM 9:03
11197
Register of Deeds Stamp & File Number

	A	B	C	D	E	F	G	H	I	J	K	L	M
1													
2	6		5		4		3		2		1		
3													
4	7		8		9		10		11		12		
5													
6	18		17		16		15		14		13		
7													
8	19		20		21		22		23		24		
9													
10	30		29		28		27		26		25		
11													
12	31		32		33		34		35		36		
13													