

\$7.00
\$2.00

SECTION

KENT COUNTY REMONUMENTATION

LAND CORNER RECORDATION CERTIFICATE Filing Requirement of Act 74, Mich. P.A. 1970

REG. OF DEEDS

[Signature]

STATE OF MICHIGAN
COUNTY OF KENT
RECEIVED FOR RECORD
1999 MAR 24 AM 9:03

For corners in

KENT COUNTY
(County)

Located in:

Corner Code #

Tyrone Twp.

1. Public Land Survey

T10N R 12W

L-11

T R

T R

T R

T R

2. Property Controlling
in Section

S T R

S T R

3. Miscellaneous
Property in Sec.

S T R

S T R

11199

Register of Deeds Stamp & File Number

4. Lot No. _____, Recorded Plat _____
5. Private Claims _____

I, Kirk Breitels, in a field survey on Jan. 26, 1999 do hereby state that under requirements of P.A. 74, Michigan P.A. of 1970, the corner points mentioned in lines 1 and 2 above were in conformance with regulations and rules therefore as required in the current manual of survey instructions of the United States Department of the Interior, Bureau of Land Management or by a decree of a Court of Law and/or that the corner points mentioned in lines 3, 4 and 5 above were in conformance with the rules of the Michigan Board of Land Surveyors or by a Decree of a Court of Law; established, re-established, monumented, recovered, found as expressed below:

NOTE: Not more than 2 corners, all in the same town and range, may be recorded on this certificate.

A	B	C	D	E	F	G	H	I	J	K	L	M
1												
2	6	5	4	3	2	1						
3												
4	7	8	9	10	11	12						
5												
6	10	17	16	15	14	13						
7												
8	19	20	21	22	23	24						
9												
10	30	29	28	27	26	25						
11												
12	31	32	33	34	35	36						
13												

A. Description of original monument and accessories and/or subsequent restoration:

L-11 1837	GLO	Whitcomb	Set Post
1975	LCRC #891	Nederveld	Iron
1982	LCRC #3009	Starr	Set Kent County Monument
1991	LCRC #6036	Byl	Kent County Monument

P.A. 345 1999 KENT COUNTY
PEER APPROVED 2/25/99
CHAIRMAN Harry Fisher

The position of this corner was previously approved by the Kent County Remonumentation Peer Group, monumented by Thomas C. Starr on 8-2-82 and was recorded per LCRC #3009.

B. Description of corner evidence found and/or method applied in restoring or reestablishing corner:

L-11 Found Kent County Monument (Harrison) per witnesses from above LCRC as set by Thomas C. Starr in place of the 1/2" Iron Pipe he found. Said Iron Pipe checks with LCRC #891.

LCRC #3009	Nail & Remon. tag 12" Tree	S75°W 89.81'	LCRC #6036	Nail & Remon. tag 14" Tree	S75°W 89.83'
	Nail & Remon. tag 6" Tree	S45°W 43.93'		Nail & Remon. tag 10" Tree	S45°W 43.93'
	Nail & Remon. tag 8" Oak	S40°E 72.52'		Nail & Remon. tag 12" Oak	S40°E 72.50'
	Nail & Remon. tag 6" Tree	S65°E 110.05'		Nail & Remon. tag 8" Tree	S65°E 110.00'
	Nail & Remon. tag 6" Willow	N40°W 71.28'		Nail & Remon. tag 8" Willow	N40°W 70.92'
	Nail & Remon. tag P. Pole	N10°E 71.47'		Nail & Remon. tag P. Pole	N10°E 71.45'

The selected location is accepted by me and is generally accepted by professional surveyors as the best available evidence of the position of the original corner.

C. Description of monument for corner and accessories established to perpetuate locating the position of the corner:

L-11 Standard Kent County Monument in Mon. Box		
Nail & KC Remon. tag N. side 14" Tree	S75°W	89.85'
Nail & KC Remon. tag NW side 10" Tree	S45°W	43.90'
Nail & KC Remon. tag NE side 12" Oak	S40°E	72.50'
Nail & KC Remon. tag S. side 10" Tree	S65°E	109.97'
Nail & KC Remon. tag S. side 10" Willow	N40°W	70.76'
Nail & KC Remon. tag W. side P. Pole	N10°E	71.45'
C/L of pavement is North 10.5' ±		

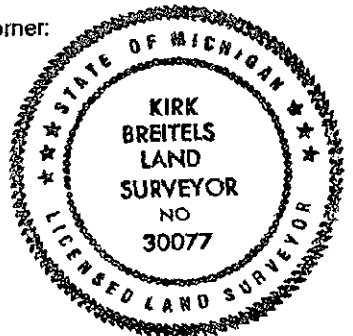

Signed by *[Signature]*
Surveyor's Michigan License No. 30077

Date 2/25/99