

1997 2 2 2000

\$7.00  
\$2.00

# KENT COUNTY REMONUMENTATION

SECTION

## LAND CORNER RECORDATION CERTIFICATE

Filing Requirement of Act 74, Mich. P.A. 1970

STATE OF MICHIGAN  
COUNTY OF KENT  
RECEIVED FOR RECORD  
1999 MAR 24 AM 8:03

REG. OF DEEDS

11202

Register of Deeds Stamp & File Number

For corners in  
KENT COUNTY  
(County)

Located In:	Corner Code #
T 10N R 12W	M-4 Tyrone Twp.
T R	Common
<del>T 10N R 11W</del>	<del>A 4 Selon Twp.</del>
T R	
S T R	
S T R	
S T R	
S T R	

1. Public Land Survey

2. Property Controlling in Section

3. Miscellaneous Property in Sec.

4. Lot No. \_\_\_\_\_, Recorded Plat \_\_\_\_\_  
5. Private Claims \_\_\_\_\_

I, Kirk Breitels, in a field survey on Feb. 18, 1999 do hereby state that under requirements of P.A. 74, Michigan P.A. of 1970, the corner points mentioned in lines 1 and 2 above were in conformance with regulations and rules therefore as required in the current manual of survey instructions of the United States Department of the Interior, Bureau of Land Management or by a decree of a Court of Law and/or that the corner points mentioned in lines 3, 4 and 5 above were in conformance with the rules of the Michigan Board of Land Surveyors or by a Decree of a Court of Law; established, re-established, monumented, recovered, found as expressed below:

1	A	B	C	D	E	F	G	H	I	J	K	L	M
2		6	5		4		3		2		1		
3													
4		7		8		9		10		11		12	
5													
6		13		17		16		15		14		13	
7													
8		19		20		21		22		23		24	
9													
10		30		29		28		27		26		25	
11													
12		31		32		33		34		35		36	
13													

NOTE: Not more than 2 corners, all in the same town and range, may be recorded on this certificate.

### A. Description of original monument and accessories and/or subsequent restoration:

M-4 1837	GLO	Brookfield	Set Post
1937	Kent Co. Wits		Dbl. Barrel of Shotgun
1974	LCRC #717	VanKooten	Dbl. Barrel of Shotgun
1980	LCRC #1747	Merdzinski	Set Kent County Monument
1991	LCRC #6040	Byl	Kent County Monument

P.A. 345 1990 KENT COUNTY  
PEER APPROVED 2/25/99  
CHAIRMAN [Signature]

The position of this corner was previously approved by the Kent County Remonumentation Peer Group, monumented by John A. Merdzinski on 12-15-80 and was recorded per LCRC #1747.

### B. Description of corner evidence found and/or method applied in restoring or reestablishing corner:

M-4 Found Kent County Monument (Harrison) per witnesses from above LCRC as set by John A. Merdzinski in place of the Dbl. Barrel of Shotgun he found. Said Dbl. Barrel of Shotgun checks with Kent Co. Wit. and LCRC #717.  
LCRC #1747  
Nail-tag 18" Oak N15°W 85.00'  
Nail-tag 6" Tri. Maple N25°E 55.31'  
Nail-tag 14" Oak S75°E 61.61'    Nail-tag 14" Oak S75°W 74.60'  
Nail-tag 14" Oak S50°E 26.97'    Nail-tag 10" Maple N70°W 48.31'  
Nail-tag 16" Oak S20°E 28.34'    Nail-tag 10" Maple N70°W 48.31'  
Nail-tag 18" Oak S45°W 53.18'    Nail-tag 24" Oak N15°W 84.84'  
Nail-tag 6" Tri. Maple N25°E 55.24'  
Nail-tag 20" Oak S75°E 61.53'    Nail-tag 20" Oak S75°W 74.57'  
Nail-tag 20" Oak S50°E 26.71'    Nail-tag 12" Maple N70°W 48.38'  
Nail-tag 24" Oak S20°E 28.34'    Nail-tag 24" Oak S45°W 53.29'

The selected location is accepted by me and is generally accepted by professional surveyors as the best available evidence of the position of the original corner.

### C. Description of monument for corner and accessories established to perpetuate locating the position of the corner:

M-4 Standard Kent County Monument	N15°W 84.84'
Nail & KC Remon. tag E. side 26" Oak	N25°E 55.29'
Nail & KC Remon. tag NW side 8" Tri. Maple	S75°E 61.56'
Nail & KC Remon. tag N. side 22" Oak	S50°E 26.74'
Nail & KC Remon. tag N. side 22" Oak	S20°E 28.34'
Nail & KC Remon. tag NE side 26" Oak	S45°W 53.29'
Nail & KC Remon. tag N. side 26" Oak	S75°W 74.61'
Nail & KC Remon. tag N. side 22" Oak	N70°W 48.40'
Nail & KC Remon. tag S. side 14" Maple	

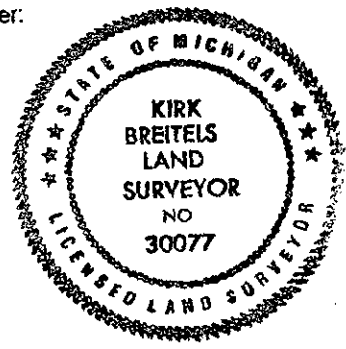

Signed by [Signature]  
Surveyor's Michigan License No. 30077

Date 2/25/99