

\$7.00
\$2.00

MAY 22 2000

KENT COUNTY REMONUMENTATION

LAND CORNER RECORDATION CERTIFICATE Filing Requirement of Act 74, Mich. P.A. 1970

For corners in SECTION _____

KENT COUNTY
(County)

Located in: Corner Code #

Tyrone Twp.

- 1. Public Land Survey
- 2. Property Controlling in Section
- 3. Miscellaneous Property in Sec.

	T	<u>10NR</u>	<u>12W</u>	<u>M-11</u>
	T	10NR	11W	A-11 Solon
	T	___	___	___
	T	___	___	___
S	T	___	___	___
S	T	___	___	___
S	T	___	___	___
S	T	___	___	___

REG. OF DEEDS

1999 MAR 24 AM 9:04

STATE OF MICHIGAN
COUNTY OF KENT
RECEIVED FOR RECORD

11207

Register of Deeds Stamp & File Number

- 4. Lot No. _____, Recorded Plat _____
- 5. Private Claims _____

I, Kirk Breitels, in a field survey on Jan. 26, 19 99 do hereby state that under requirements of P.A. 74, Michigan P.A. of 1970, the corner points mentioned in lines 1 and 2 above were in conformance with regulations and rules therefore as required in the current manual of survey instructions of the United States Department of the Interior, Bureau of Land Management or by a decree of a Court of Law and/or that the corner points mentioned in lines 3, 4 and 5 above were in conformance with the rules of the Michigan Board of Land Surveyors or by a Decree of a Court of Law; established, re-established, monumented, recovered, found as expressed below:

NOTE: Not more than 2 corners, all in the same town and range, may be recorded on this certificate.

	A	B	C	D	E	F	G	H	I	J	K	L	M
1													
2		6		5		4		3		2		1	
3													
4		7		8		9		10		11		12	
5													
6		18		17		16		15		14		13	
7													
8		19		20		21		22		23		24	
9													
10		30		29		28		27		26		25	
11													
12		31		32		33		34		35		36	
13													

A. Description of original monument and accessories and/or subsequent restoration:

M-11 1837	GLO	Whitcomb	Set Post
1967	Kent Co. Wits		3/4" Iron
1979	LCRC #1274	Stadt	1 1/4" Iron in Mon. Box
1983	LCRC #3248	Byl	Set Kent County Monument
1991	LCRC #6047	Byl	Kent County Monument

P.A. 345 1990 KENT COUNTY
PEER APPROVED 2/25/99
CHAIRMAN Harry Huber

The position of this corner was previously approved by the Kent County Remonumentation Peer Group, monumented by William R. Byl on 2-28-83 and was recorded per LCRC #3248.

B. Description of corner evidence found and/or method applied in restoring or reestablishing corner:

M-11 Found Kent County Monument (Harrison) per witnesses from above LCRC as set by William R. Byl in place of the 1 1/4" Iron over a 1" Iron over a Conc. Mon. in a Mon. Box he found. All check with Kent Co. Wits. and LCRC #1247.

LCRC #3248		LCRC #6047	
Nail & Remon. tag 36" Oak	S20°W 74.79'	Nail & Remon. tag 16" Pine	N40°W 117.80'
Nail & Remon. tag 12" Pine	N40°W 117.84'	Nail & Remon. tag 12" Tri. Cherry	N70°W 107.76'
Nail & Remon. tag 12" Tri. Cherry	N70°W 107.76'	Nail & Remon. tag 30" Oak	S20°E 101.43'
Nail & Remon. tag 30" Oak	S20°E 101.43'	Nail & Remon. tag P. Pole	N35°E 71.64'

The selected location is accepted by me and is generally accepted by professional surveyors as the best available evidence of the position of the original corner.

C. Description of monument for corner and accessories established to perpetuate locating the position of the corner:

M-11 Standard Kent County Monument in Mon. Box

Nail & KC Remon. tag N. side 22" Pine	N40°W 117.84'
Nail & KC Remon. tag S. side Tri. 15" Cherry	N70°W 107.79'
Nail & KC Remon. tag W. side 36" Oak	S20°E 101.48'
Nail & KC Remon. tag NW side P. Pole	N35°E 71.64'

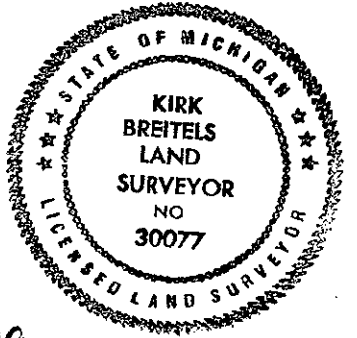

Signed by Kirk Breitels
Surveyor's Michigan License No. 30077

Date 2/25/99