

MAY 22 2008

KENT COUNTY REMONUMENTATION

SECTION

LAND CORNER RECORDATION CERTIFICATE  
Filing Requirement of Act 74, Mich. P.A. 1970

For corners in

KENT COUNTY  
(County)

Located In:

Corner Code #

Tyrone Twp.  
B-8

1. Public Land Survey

T 10NR 12W  
T R  
T R  
T R

\_\_\_\_\_  
\_\_\_\_\_  
\_\_\_\_\_  
\_\_\_\_\_

2. Property Controlling in Section

S T R  
S T R  
S T R  
S T R

\_\_\_\_\_  
\_\_\_\_\_  
\_\_\_\_\_  
\_\_\_\_\_

3. Miscellaneous Property in Sec.

4. Lot No. \_\_\_\_\_, Recorded Plat \_\_\_\_\_  
5. Private Claims \_\_\_\_\_

Seg. 2

REC'D OF DEEDS

1999 DEC 30 AM 9:20

RECEIVED FOR RECORD

11680

Register of Deeds Stamp & File Number

I, Kirk Breitels, in a field survey on Nov. 23, 19 99 do hereby state that under requirements of P.A. 74, Michigan P.A. of 1970, the corner points mentioned in lines 1 and 2 above were in conformance with regulations and rules therefore as required in the current manual of survey instructions of the United States Department of the Interior, Bureau of Land Management or by a decree of a Court of Law and/or that the corner points mentioned in lines 3, 4 and 5 above were in conformance with the rules of the Michigan Board of Land Surveyors or by a Decree of a Court of Law; established, re-established, monumented, recovered, found as expressed below:

1	A	B	C	D	E	F	G	H	I	J	K	L	M
2	6	5	4	3	2	1							
3													
4	7	8	9	10	11	12							
5													
6	18	17	16	15	14	13							
7													
8	19	20	21	22	23	24							
9													
10	30	29	28	27	26	25							
11													
12	31	32	33	34	35	36							
13													

NOTE: Not more than 2 corners, all in the same town and range, may be recorded on this certificate.

A. Description of original monument and accessories and/or subsequent restoration:

- B-8 Kent County Monument, LCRC #8746
  - Nail & KC Remon. tag NE side 18" Apple N50°W 31.86'
  - Nail & KC Remon. tag W. side 3" Apple S30°W 27.63'
  - Nail & KC Remon. tag SW side 6" Apple S50°E 32.62'
  - Nail & KC Remon. tag SE side 3" Apple N60°E 31.31'
  - Iron Pipe S70°E 2.45'
  - C/L orchard trail N-S is West 5' ±
  - C/L orchard trail East is North 6' ±
  - C/L orchard trail West is South 6' ±

P.A. 845 1999 KENT COUNTY  
PEER APPROVED 10/25/99  
CHAIRMAN Henry Huber

B. Description of corner evidence found and/or method applied in restoring or reestablishing corner:

- B-8 Found BROKEN Kent County Monument
  - Fd. Nail & KC Remon. W. side 6" Apple S30°W 27.61'
  - Fd. Nail & KC Remon. SW side 6" Apple S50°E 32.65'
  - Fd. Nail & KC Remon. SE side 6" Apple N60°E 31.29'
  - Iron Pipe (bent badly) S70°E 2.45' ±

All orchard trail the same

C. Description of monument for corner and accessories established to perpetuate locating the position of the corner:

- B-8 Removed and Replaced Standard Kent County Monument
  - Nail & KC Remon. tag W. side 6" Apple S30°W 27.61'
  - Nail & KC Remon. tag SW side 6" Apple S50°E 32.65'
  - Nail & KC Remon. tag SE side 6" Apple N60°E 31.29'
  - Nail & KC Remon. tag N. side 6" Apple S75°W 66.91'
  - C/L orchard trail N-S is West 5' ±
  - C/L orchard trail East is North 6' ±
  - C/L orchard trail West is South 6' ±

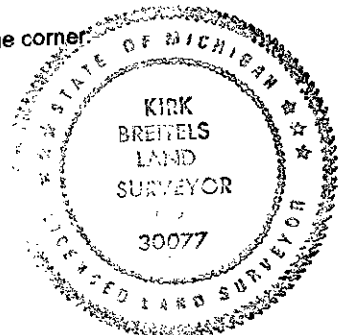

Signed by Kirk Breitels  
Surveyor's Michigan License No. 30077

Date 12/28/99