

JAN 05 2000

SECTION

LAND CORNER RECORDATION CERTIFICATE
Filing Requirement of Act 74, Mich. P.A. 1970

For corners in

Keweenaw
(County)

Located In:	Corner Code #
T 57 R 33	M-9 ✓
T 57 R 33	L-9
T R	
T R	
S T R	
S T R	
S T R	
S T R	

1. Public Land Survey

2. Property Controlling in Section

3. Miscellaneous Property in Sec.

4. Lot No. _____, Recorded Plat _____
5. Private Claims _____

REGISTER'S OFFICE
County of Keweenaw } SS 13th
Received for Record, the _____
day of December A.D. 19 99
at 1:00 o'clock P. M., and Recorded
in Liber 1 of LCR
on page 215
John Carlson, Deputy
Register of Deeds

Register of Deeds Stamp & File Number

I, James M. Pardini, in a field survey on 9/14, 19 99 do hereby state that under requirements of P.A. 74, Michigan P.A. of 1970, the corner points mentioned in lines 1 and 2 above were in conformance with regulations and rules therefore as required in the current manual of survey instructions of the United States Department of the Interior, Bureau of Land Management or by a decree of a Court of Law and /or that the corner points mentioned in lines 3, 4 and 5 above were in conformance with the rules of the Michigan Board of Land Surveyors or by a Decree of a Court of Law; established, re-established, monumented, recovered, found as expressed below:

NOTE: Not more than 2 corners, all in the same town and range, may be recorded on this certificate.

A	B	C	D	E	F	G	H	I	J	K	L	M
1												
2	6	5	4	3	2							
3												
4	7	8	9	10	11	12						
5												
6	18	17	16	15	14	13						
7												
8	19	20	21	22	23	24						
9												
10	30	29	28	27	26	25						
11												
12	31	32	33	34	35	36						
13												

A. Description of original monument and accessories and/or subsequent restoration:
(M-9) SE Corner section 24 T57N-R33W
Wood post set for section corner by Austin Burt DS in 1845. U.S. Bearing Trees:
16" Cedar S14°W 38 lks
16" Cedar N50°W 19 lks
Samuel W. Hill DS 112°? Spruce N20°E 23 lks
Subdivision T57N-R33W 10" Fir S60°E 33 lks

(L-9) S 1/2 corner section 24 T57N-R33W
2" diameter Hemlock post set for quarter section corner by Samuel W. Hill in 1846. U.S. Bearing Trees:
20" Yellow Birch N10°E 6 lks
12" Fir S30°W 4 lks

B. Description of corner evidence found and/or method applied in restoring or reestablishing corner:
(M-9) Calumet and Hecla Mining Co., records call for 3" pipe in stamp sand on North side of Hills Creek found and noted by Walt Kline in 1950. Found and accepted 3" o.d. iron pipe 30" A.G.
(L-9) Re-established 1/2 corner by single proportionate measure between section corners East and West.

Ratified by Peer Group
In accordance with P.A. 345
Co. Rep. James M. Pardini
Date 12/7/99

C. Description of monument for corner and accessories established to perpetuate locating the position of the corner:
(M-9) Cemented 4" brass cap marked "Keweenaw Co., Remonumentation Point" to top of 3" o.d. iron pipe.

- 10" Cedar S50°E 29.17'
- 12" Cedar S16°W 36.37'
- 4" Cedar N41°W 9.69'
- 4" White Birch S76°E 8.79'
- (L-9) Set 1"x36" iron pipe 24" in ground /w 4" brass cap marked "Keweenaw Co., Remonumentation Point".
- 12" Red Maple S72°W 38.61' 10" Red Maple S32°E 40.62'
- 8" Red Maple N62°W 31.36'
- 8" Red Maple N04°E 51.23'

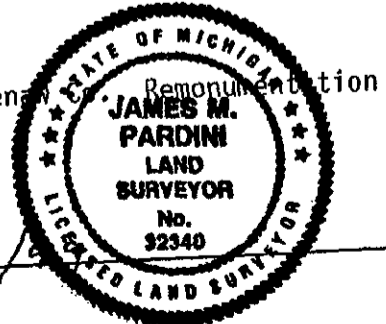

Signed by James M. Pardini
Surveyor's Michigan License No. 32340

Date 12/7/99