

FEB 08 2000



LC-000002
Page: 1 of 1
03/26/1999 03:44P
Bk-2 Pg-455

SECTION

LAND CORNER RECORDATION CERTIFICATE
Filing Requirement of Act 74, Mich. P.A. 1970

For corners in COMSTOCK TWP
KALAMAZOO

Located In: Corner Code #

- 1. Public Land Survey T 25. R 10W. H-3
- 2. Property Controlling in Section S T R
- 3. Miscellaneous Property in Sec. S T R

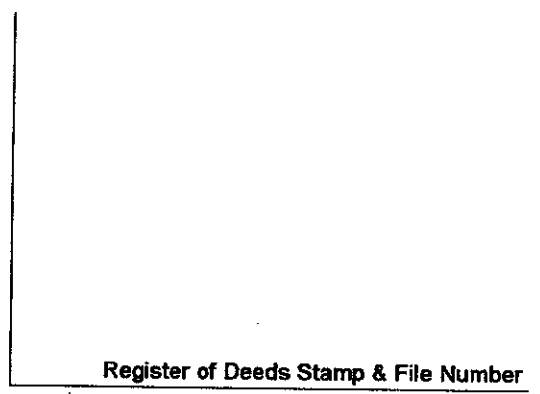

- 4. Lot No. _____, Recorded Plat _____
- 5. Private Claims _____
- 6. IWM Job No. 23344

I, Allen H. McMachen, in a field survey on March 2, 1999 do hereby state that under requirements of P.A. 74, Michigan P.A. of 1970, the corner points mentioned in lines 1 and 2 above were in conformance with regulations and rules therefore as required in the current manual of survey instructions of the United States Department of the Interior, Bureau of Land Management or by a decree of a Court of Law and/or that the corner points mentioned in lines 3, 4 and 5 above were in conformance with the rules of the Michigan Board of Land Surveyors or by a Decree of a Court of Law; established, re-established, monumented, recovered, found as expressed below:

NOTE: Not more than 2 corners, all in the same town and range, may be recorded on this certificate.

A	B	C	D	E	F	G	H	I	J	K	L	M
2	6	5	4	3	2	1						
3												
4	7	8	9	10	11	12						
5												
6	18	17	16	15	14	13						
7												
8	19	20	21	22	23	24						
9												
10	30	29	28	27	26	25						
11												
12	31	32	33	34	35	36						
13												

A. Description of original monument and accessories and/or subsequent restoration:

- 1827 - Robert Clark Jr., D.S., Set quarter Sec. post, Wh. Oak 18" N. 36° W. 9 lks., Y. Oak 18" N. 84° E. 25 lks..
- 1885 - F. Hodgman, C.S., "Lost. Set post on line midway between Section corners East and West, Hickory 6" N. 1/2° W. 52 1/2 lks., Wh. Oak 6" S. 61 1/2° E. 86 1/2 lks..

RATIFIED
BY KALAMAZOO COUNTY
REMONUMENTATION
PEER GROUP
3/18/99 R.E.G.

B. Description of corner evidence found and/or method applied in restoring or reestablishing corner:

Found clay tile 0.23 feet North and 0.88 feet West of bisection of Section line between a standard marker at the Southwest corner, Section 3, and a standard marker at the Southeast corner, Section 3. Found surface marker (flat iron 2.8 feet long) 2.85 feet South and 4.20 feet East of found tile. Top section of tile was 6 inches below grade.

C. Description of monument for corner and accessories established to perpetuate locating the position of the corner:

Found clay tile is accepted as a careful and faithful reestablishment of the position of the original corner. Placed standard sleeve over clay tile with monument box over, Accessories:

- Nail & Tab in West side U. Pole N. 20° E. 20.34'
- Nail & Tab (5' high) in Service Pole N. 45° E. 61.88'
- Nail & Tab in West side 8" Oak S. 15° E. 23.37'
- "PK" Nail (existing) in NW side 10" Hickory S. 45° W. 31.40'

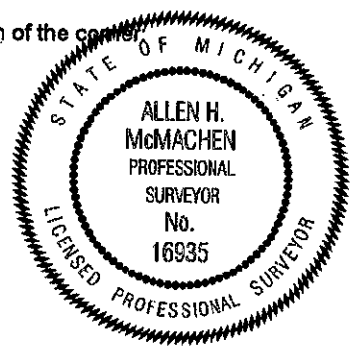

Signed by Allen H. McMachen
Surveyor's Michigan License No. 16935

Date 3/22/99