

**SURVEY & REMONUMENTATION**

**FEB 26 1998**

**SECTION**

**LAND CORNER RECORDATION CERTIFICATE**  
**Filing Requirement of Act 74, Mich. P.A. 1970**

For corners in

<u>Kalamazoo</u>	Located In:	Corner Code#
(County)		
<b>Oshtemo Township</b>		
1. Public Land Survey	T <u>2S</u> R <u>12W</u>	<u>A-12</u>
	T _____ R _____	_____
	T _____ R _____	_____
	T _____ R _____	_____
2. Property Controlling in Section	S _____ T _____ R _____	_____
	S _____ T _____ R _____	_____
3. Miscellaneous Property in Sec.	S _____ T _____ R _____	_____
	S _____ T _____ R _____	_____

4. Lot No. \_\_\_\_\_, Recorded Plat \_\_\_\_\_

5. Private Claims \_\_\_\_\_

STATE OF MICHIGAN  
 COUNTY OF KALAMAZOO  
 RECEIVED FOR RECORD

1997 DEC 23 PM 12 56

LIBER 2 PAGE 267

CLERK - REGISTER

Register of Deeds Stamp & File Number

I, Gary D. Hahn, in a field survey on April 8, 19 97 do hereby state that under requirements of P.A. 74, Michigan P.A. of 1970, the corner points mentioned in lines 1 and 2 above were in conformance with regulations and rules therefore as required in the current manual of survey instructions of the United States Department of the Interior, Bureau of Land Management or by a decree of a Court of Law and /or that the corner points mentioned in lines 3, 4 and 5 above were in conformance with the rules of the Michigan Board of Land Surveyors or by a Decree of a Court of Law; established, re-established, monumented, recovered, found as expressed below:

**NOTE: Not more than 2 corners, all in the same town and range, may be recorded on this certificate.**

A	B	C	D	E	F	G	H	I	J	K	L	M
1												
2	6		5		4		3		2		1	
3												
4	7		8		9		10		11		12	
5												
6	18		17		16		15		14		13	
7												
8	19		20		21		22		23		24	
9												
10	30		29		28		27		26		25	
11												
12	31		32		33		34		35		36	
13												

A. Description of original monument and accessories and/or subsequent restoration:

Corner not established during original Government Land Office Survey.  
 No land corner recordation certificates on file at Register of Deeds.

Date - ? KCRC witness tie notes call for a RR spike.  
 Witness ties: 13" Oak N 45 deg. W 60.61 feet.  
 11" Oak S 65 deg. W 43.18 feet.  
 44" Oak S 35 deg. E 67.89 feet.

**RATIFIED**  
**BY KALAMAZOO COUNTY**  
**REMONUMENTATION**  
**PEER GROUP**  
 8/21/97

B. Description of corner evidence found and/or method applied in restoring or reestablishing corner:

Found nothing at this location. Found a RR spike at the East Quarter Post of Section 36, Almema Township. The position of this RR spike has recently been ratified by the Van Buren County Remonumentation Peer Group. The road way in this area appears to have been cut about 2 feet. Dug a 4' x 6' hole and hit virgin soil almost immediately. Dug to depth of 5 feet in sand. No corner evidence found. Set a 20" Harrison Monument on the east line of Almema Township, Van Buren County at the calculated jog of 1.65 feet south of the previously ratified position of the east quarter post of Section 36, Almema Township.

C. Description of monument for corner and accessories established to perpetuate locating the position of the corner:

A-12, West Quarter Post Section 31, Town 2 South, Range 12 West, ratified by Kalamazoo County Remonumentation Peer Group on August 21, 1997. This position not established by original government surveyors. This monument is accepted as the best available evidence of the position of the corner.

Witness ties: Set PK nail in 20" Oak S 65 deg. W 40.78 feet.  
 Set PK nail in 36" Oak S 45 deg. E 62.85 feet.  
 Set PK nail in Fence post East 28.59 feet.  
 Set PK nail in 20" Oak N 45 deg. W 61.25 feet.

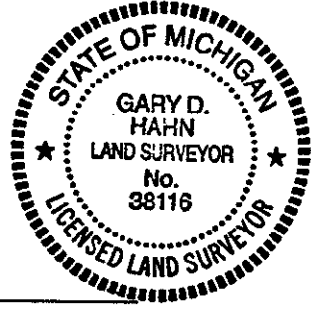

Signed by [Signature]  
 Surveyor's Michigan License No. 38116

Date 12/19/97