

**SURVEY &  
REMONUMENTATION**

7 MAY 28 1997

2 COMMISSION

**LAND CORNER RECORDATION CERTIFICATE  
Filing Requirement of Act 74, Mich. P.A. 1970**

LIBER

2 PAGE 104

For corners in

<u>Kalamazoo</u> (County)	Located In:	Corner Code #
Oshemo Twp.		
1. Public Land Survey	T <u>2S</u> R <u>12W</u>	<u>D2</u>
	T _____ R _____	_____
	T _____ R _____	_____
	T _____ R _____	_____
2. Property Controlling in Section	S _____ T _____ R _____	_____
	S _____ T _____ R _____	_____
3. Miscellaneous Property in Sec.	S _____ T _____ R _____	_____
	S _____ T _____ R _____	_____

STATE OF MICHIGAN  
COUNTY OF KALAMAZOO  
RECEIVED FOR RECORD  
'96 DEC 31 PM 3 21  
Register of Deeds Stamp & File Number

CLFRK-REGISTER

4. Lot No. \_\_\_\_\_, Recorded Plat \_\_\_\_\_  
5. Private Claims \_\_\_\_\_

I, Gary D. Hahn, in a field survey on May 6, 19 96 do hereby state that under requirements of P.A. 74, Michigan P.A. of 1970, the corner points mentioned in lines 1 and 2 above were in conformance with regulations and rules therefore as required in the current manual of survey instructions of the United States Department of the Interior, Bureau of Land Management or by a decree of a Court of Law and /or that the corner points mentioned in lines 3, 4 and 5 above were in conformance with the rules of the Michigan Board of Land Surveyors or by a Decree of a Court of Law; established, re-established, monumented, recovered, found as expressed below:

**NOTE: Not more than 2 corners, all in the same town and range, may be recorded on this certificate.**

A	B	C	D	E	F	G	H	I	J	K	L	M
1												
2	6		●		4		3		2		1	
3												
4	7		8		9		10		11		12	
5												
6	18		17		16		15		14		13	
7												
8	19		20		21		22		23		24	
9												
10	30		29		28		27		26		25	
11												
12	31		32		33		34		35		36	
13												

**A. Description of original monument and accessories and/or subsequent restoration:**

This corner not established during original G.L.O. survey.  
1904 E. Strong: Ran both quarter lines. Set stone at intersection.  
1982 Al McMachen, L.C.R.C. L.1, P. 844: iron rod  
Date? KCRC witness notes: Fnd. drilled stone and brought to surface with iron (1/2").  
24" Maple North 15 degrees East 137.22' 5" tele. pole South 45 degrees West 42.3' 24" Hick. South 45 degrees East 32.0' In line of fence-E. 1/2" iron (Gove 5-8-63) 12" Cherry South 35 degrees West 40.16' T.P. North 65 degrees West 36.65' 20" Hickory South 45 degrees East 31.55' P.P.# 82-50 North 85 degrees East 47.97'

**B. Description of corner evidence found and/or method applied in restoring or reestablishing corner:**

Found a 1/2" square rebar 3" below road surface. Dug down to find a 7" X 12" X 10" stone with drill mark surrounded by red clay brick pieces. Stone was directly below square rebar.

**RATIFIED  
BY KALAMAZOO COUNTY  
REMONUMENTATION  
PEER GROUP  
6-20-1996**

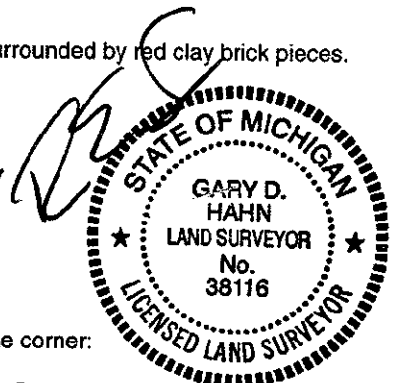

**C. Description of monument for corner and accessories established to perpetuate locating the position of the corner:**

D2, Center Section 5, Town 2 South, Range 12 West, ratified by Kalamazoo County Remonumentation Peer Group on June 20, 1996.  
7"X12"X10" stone with drill mark believed to be same as set by E. Strong in 1904. This position not established by original government surveyors. The position of the stone is accepted as the best available evidence of the position of the corner. Set a 20" Harrison Monument over stone in a mon. box.  
Set P.K. nail in 30" Hickory South 55 degrees East 31.18'  
Set P.K. nail in 16" Twin Cherry South 32 degrees West 39.81'  
Set P.K. nail in 8" Hickory North 83 degrees West 29.80'  
Set P.K. nail in P.P. North 22 degrees East 77.48'

Signed by *Gary D. Hahn*  
Surveyor's Michigan License No. 38116

Date 12/31/96