

LAND CORNER RECORDATION CERTIFICATE
Filing Requirement of Act 74, Mich. P.A. 1970

For corners in

Kalamazoo Located In: Corner Code#
 (County)
 Climax Twp.
 1. Public Land Survey T 3S R 9W A7
 T R
 T R
 T R
 2. Property Controlling S T R
 in Section S T R
 3. Miscellaneous S T R
 Property in Sec. S T R

SURVEY & REMONUMENTATION
FEB 08 2000
SECTION
Register of Deeds Stamp & File Number

4. Lot No. _____, Recorded Plat _____
 5. Private Claims _____

I, Gary D. Hahn, in a field survey on August 25, 1999 do hereby state that under requirements of P.A. 74, Michigan P.A. of 1970, the corner points mentioned in lines 1 and 2 above were in conformance with regulations and rules therefore as required in the current manual of survey instructions of the United States Department of the Interior, Bureau of Land Management or by a decree of a Court of Law and /or that the corner points mentioned in lines 3, 4 and 5 above were in conformance with the rules of the Michigan Board of Land Surveyors or by a Decree of a Court of Law; established, re-established, monumented, recovered, found as expressed below:

1	A	B	C	D	E	F	G	H	I	J	K	L	M
2	6		5		4		3		2		1		
3													
4	7		8		9		10		11		12		
5													
6	18		17		16		15		14		13		
7													
8	19		20		21		22		23		24		
9													
10	30		29		28		27		26		25		
11													
12	31		32		33		34		35		36		
13													

NOTE: Not more than 2 corners, all in the same town and range, may be recorded on this certificate.

A. Description of original monument and accessories and/or subsequent restoration:

1826 - Corner established by U.S. Deputy Surveyor Robert Clark, Jr.: "Intersected the West boundary 127 lks. South of post. Set post at intersection of corner to Sections 18 + 19. W. Oak 24 N 20 ° E 35 ½ lks. Wh. Oak 8 S 14 ° E 19 lks."

1871 - S. Hodgman: "Found stake set by Stimson from Elm witness tree. Bearing + distance correct. Distance also correct to Hickory tree but found the bearing to be N 37 ° W"

1872 - F. Hodgman: "At the corner of secs. 18 + 19 Climax on the range line found old stake from two new witnesses and old witness stump. Planted a new stake."

1883 - F. Hodgman: "Corner gone in swamp. At intersection of fence and N 60 W 29 lks. from stump of Black Ash set 3 feet of Jackson Earthen post and marked Maple 6" S 78 ° W 46 ½ lks. Elm 12" N 30 ° W 53 1/4 lks."

B. Description of corner evidence found and/or method applied in restoring or reestablishing corner:

Original corner and accessories not recovered. Found tile. Top half of top piece of tile was broken off. Found full section of tile below bottom half of top section. Top of remaining tile is 2.7 feet below road surface.

C. Description of monument for corner and accessories established to perpetuate locating the position of the corner:

A7, Southwest Corner of Section 18, Town 3 South, Range 9 West. Ratified by the Kalamazoo County Remonumentation Peer Group on September 23, 1999. The location of the tile is accepted as a careful and faithful perpetuation of the position of the original corner. Set a 20" Harrison Monument in a monument box directly over found tile.

- Witness Ties:
- Found a Harrison Monument in a monument box North 84.00 feet (Pavilion corner M7)
 - Found Mag nail in N side of power pole N 88 ° E 22.76 feet
 - Found Mag nail w/tab in power pole N 40 ° W 55.60 feet
 - Found nail in power pole S 30 ° E 43.39 feet
 - NE Corner of concrete foundation of house at 8022 36th Street S 45 ° W 70.23 feet

RATIFIED
BY KALAMAZOO COUNTY
REMONUMENTATION
PEER GROUP
 9-23-1999

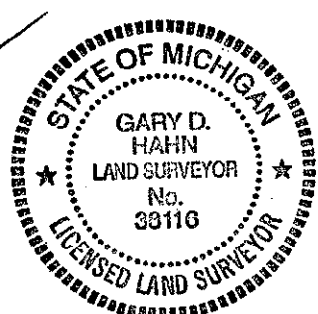

Signed by [Signature]
 Surveyor's Michigan License No. 38116

Date 10/18/99