

LAND CORNER RECORDATION CERTIFICATE
Filing Requirement of Act 74, Mich. P.A. 1970

For corners in
KALAMAZOO

Located In: _____ Corner Code M-7

1. Public Land Survey	T	<u>3S</u>	R	<u>12W</u>	<u>M-7</u>
	T	<u>3S</u>	R	<u>12W</u>	<u>M-8</u>
	T	_____	R	_____	_____
	T	_____	R	_____	_____
2. Property Controlling In Section	S	_____	T	_____	_____
	S	_____	T	_____	_____
3. Miscellaneous Property in Sec.	S	_____	T	_____	_____
	S	_____	T	_____	_____

Register of Deeds Stamp & File Number

4. Lot No. _____, Recorded Plat _____
 5. Private Claims _____

	A	B	C	D	E	F	G	H	I	J	K	L	M
2	6		5		4		3		2		1		
3													
4	7		8		9		10		11		12		
5													
6	18		17		16		15		14		13		
7													
8	19		20		21		22		23		24		
9													
10	30		29		28		27		26		25		
11													
12	31		32		33		34		35		36		
13													

I, GARY C. BILOW, in a field survey on AUGUST 15, 19 90, do hereby certify that under requirements of P.A. 74, Michigan P.A. of 1970, the corner points mentioned in lines 1 and 2 above were in conformance with regulations and rules therefore as required in the current manual of survey instructions of the United States Department of the Interior, Bureau of Land Management or by a decree of a Court of Law and/or that the corner points mentioned in lines 3, 4 and 5 above were in conformance with the rules of the Michigan Board of Land Surveyors or by a Decree of a Court of Law; established, re-established, monumented, re-monumented, recovered, found as expressed below:

NOTE: Not more than 4 corners, all in the same town and range, may be recorded on this certificate.

A. Description of original monument and accessories and/or subsequent restoration:

(M-7) CORNER POST ESTABLISHED BY U.S. GOVERNMENT DEPUTY SURVEYOR WM. BROOKFIELD, 1827. ACCESSORIES: W. OAK 8 S77W 17, W. OAK 7 N33W 1.50. CORNER FOUND BY MICHIGAN STATE HIGHWAY DEPARTMENT DEC. 1959 AS 3/8" IRON ROD. MSHD ACCESSORIES: 21" OAK N72E, 91.42', 6" OAK S54E 44.73'.

(M-8) CORNER POST ESTABLISHED BY U.S. GOVERNMENT DEPUTY SURVEYOR WM. BROOKFIELD, 1827. ACCESSORIES: W. OAK 9 S41W 3.16, Y. OAK 14 N78-1/2W 1.43. 3/8" IRON ROD FOUND BY MSHD DEC. 1959. MSHD ACCESSORIES ARE: T. POLE N53E 61.60', 4" OAK N50W 73.39', 21" OAK S60W 72.15'. BOTH ABOVE CORNERS ARE NOTED IN BOOK 5 OF B OF MSHD PROJECT NO. CS 39013 RN.

B. Description of corner evidence found and/or method applied in restoring or reestablishing corner:

(M-7) ORIGINAL CORNER POST AND ACCESSORIES NOT RECOVERED. FOUND AND ACCEPTED 1/2" REINFORCING ROD IN MONUMENT BOX AGREEING WITH GLO FALLING OF 24.4' SOUTH OF THE NW CORNER OF SECTION 19, T3S-R11W.

(M-8) ORIGINAL CORNER POST AND ACCESSORIES NOT RECOVERED. FOUND AND ACCEPTED 1/2" REINFORCING ROD. DISTANCE BETWEEN M-7 AND M-8 CHECKS 0.82' SHORTER THAN 1959 MSHD MEASUREMENT. MSHD TIE TO 21" OAK CHECKED.

C. Description of monument for corner and accessories established to perpetuate locating the position of the corner:

(M-7) FOUND 1/2" REBAR IN MONUMENT BOX

(M-8) FOUND 1/2" REBAR

N14W 101.73' SET NAIL AND MICHIGAN DEPT. OF NATURAL RESOURCES TAG IN W. FACE POWER POLE
 N66W 37.18' SET NAIL AND MDNR TAG IN N. FACE 18" OAK
 S16W 114.27' SET NAIL AND MDNR TAG IN E. FACE POWER POLE
 NORTH 24.57' FOUND 1/2" REBAR IN MONUMENT BOX AT NW CORNER OF SECTION 19, T3S-R11W.

S61W 45.10' SET NAIL AND MDNR TAG IN E. FACE 10" CHERRY
 N68E 35.57' SET NAIL AND MDNR TAG IN N. FACE 6" ELM
 N24W 66.22' SET NAIL AND MDNR TAG IN SW FACE 12" OAK
 NORTH 24.57' FOUND 1/2" REBAR AT WEST 1/4 CORNER SECTION 19,

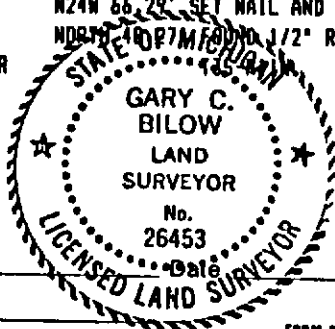

Signed by Gary C. BiLow
 Surveyor's Michigan License No. 26453

2/8/91