

**JAN 25 2001**

**SECTION**

**LAND CORNER RECORDATION CERTIFICATE**

FILING REQUIREMENT OF ACT 74, Mich. P.A. 1970

RECORDED  
LAKE COUNTY, MI.  
LIBER 004 PAGE 0233

MAY 5 10 24 AM '00

*Shelley Myers*  
REGISTER OF DEEDS

For corners in Lake _____	Located in:	Corner Code#
1. Public Land Survey	T 18 N R 11 W	C-8
	T R	
	T R	
	T R	
2. Property Controlling in Section	S T R	
	S T R	
3. Miscellaneous Property in Sec.	S T R	
	S T R	
4. Lot No. _____ Recorded Plat _____		
5. Private Claims _____		

Register of Deeds Stamp & File Number

	A	B	C	D	E	F	G	H	I	J	K	L	M
1													
2	6	5	4	3	2	1							
3													
4	7	8	9	10	11	12							
5													
6	18	17	16	15	14	13							
7													
8	19	20	21	22	23	24							
9													
10	30	29	28	27	26	25							
11													
12	31	32	33	34	35	36							
13													

I, Robert L. Wetherell, in a field survey on March 24, 2000, do hereby certify that under requirements of P.A. 74, Michigan P.A. of 1970, the corner points mentioned in lines 1 and 2 above were in conformance with regulations and rules therefore as required in the current manual of survey instructions of the United States Department of the Interior, Bureau of Land Management or by decree of a Court of Law and/or that the corner points mentioned in lines 3, 4, and 5 above were in conformance with the rules of the Michigan Board of Land Surveyors or by a Decree of a Court of Law; established, re-established, monumented, re-monumented, recovered, found as expressed below:

**C-8 - 1/4 Corner common to Sections 19 & 20, T18N, R11W**

**A. Description of original monument and accessories and/or subsequent restoration:**

**1838 - J. Hodgson, G.L.O.**

- #1 - 20" Pine S67°E 21 Links
- #2 - 8" Maple N89°W 16 Links

**1904 - R.H. Hollister, Co. Sur.**

- "Found Post - Set 2 pieces of strap iron".
- #3 - 24" Pine Stump N66°W 28 1/2 Links
- #1 - 20" Pine S67°E 21 Links
- #4 - Measures 2697' South to Sec. Cor.

**1973 - C. Cole, LS 17615**

Survey recorded L. 01, Pg. 306  
Positioned corner by single proportionate method 2636.44' each way.  
Did not set. Corner fell in beaver pond.

**B. Description of corner evidence found and/or method applied in restoring or reestablishing corner:**

I found the two pieces of strap iron by Hollister surrounded by three stones. Corner is in line with old fence (down) running North and South. It is North of an old beaver dam. The computed position by Cole would be 67 feet more or less South of this corner.

Condition of the accessories are as follows: #1 Found stump, #2 Gone, #3 Found in good condition, #4 Measured 2703' more or less.

**C. Description of monument for corner and accessories established to perpetuate locating the position of the corner:**

I set a 3/4" x 24" rebar with Lake County Remon Cap over the two pieces of strap iron, and is accepted as a careful and faithful perpetuation of the position of the original corner.

- 12" Maple N61°W 109.25' (60d spike N. side)
- 12" Maple N45°W 84.73' (60d spike N.E. side)
- 14" Cedar S86°E 287.40' (60d spike N. side)
- 4" W. Pine S39°E 246.53' (60d spike N. side)
- 8" Elm S01°W 101.16' (60d spike E. side)

NOTIFIED BY THE LAKE COUNTY REVIEW GROUP  
IN ACCORDANCE WITH P.A. 345  
SURVEYOR R.L.W.  
DATE 4-11-2000

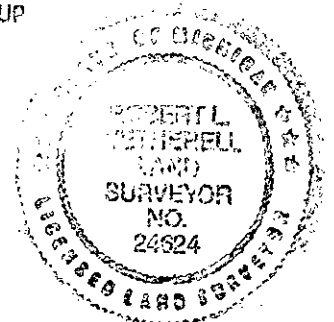

Signed by Robert L. Wetherell  
Surveyor's Michigan License No. 24624

Date April 12, 2000