

SECTION

LAND CORNER RECORDATION CERTIFICATE
Filing Requirement of Act 74, Mich. P.A. 1970

LIBER 004 PAGE 0168

For corners in
Lake _____

	Located In:	Corner Code #		
		19N	12W	K-5
1. Public Land Survey	T	R	_____	
	T	R	_____	
	T	R	_____	
	T	R	_____	
2. Property Controlling in Section	S	T	R	_____
	S	T	R	_____
3. Miscellaneous Property in Sec.	S	T	R	_____
	S	T	R	_____

REGISTERED
 LAKE COUNTY, MI
 Oct 29 4 40 PM '98
 REGISTER OF DEEDS
 Register of Deeds State & File Number

4. Lot No. _____, Recorded Plat _____
 5. Private Claims _____

Robert L. Wetherell July 16, 98

I, _____, in a field survey on _____, 19____ do hereby state that under requirements of P.A. 74, Michigan P.A. of 1970, the corner points mentioned in lines 1 and 2 above were in conformance with regulations and rules therefore as required in the current manual of survey instructions of the United States Department of the Interior, Bureau of Land Management or by a decree of a Court of Law and /or that the corner points mentioned in lines 3, 4 and 5 above were in conformance with the rules of the Michigan Board of Land Surveyors or by a Decree of a Court of Law; established, re-established, monumented, recovered, found as expressed below:

NOTE: Not more than 2 corners, all in the same town and range, may be recorded on this certificate.

1	A	B	C	D	E	F	G	H	I	J	K	L	M
2	6	5	4	3	2	1							
3													
4	7	8	9	10	11	12							
5													
6	18	17	16	15	14	13							
7													
8	19	20	21	22	23	24							
9													
10	30	29	28	27	26	25							
11													
12	31	32	33	34	35	36							
13													

A. Description of original monument and accessories and/or subsequent restoration:

K-5 - Section corner common to Sections 11, 12, 13 & 14, T19N, R12W, Lake Co., Mi.

- | | | |
|------------------------------------|---|---------------------------------------|
| 1838 - S. Sibley, G.L.O. | 1906 - J.W. Nichoson, Co. Sur. | 1960 - G. Blass, LS 5489 |
| #1 - 10" Beech N45°E 5 Links | "Old corner stake dug up in grade. | 1-1/4" Pipe (raised with timber pin) |
| #2 - 12" Pine S7°W 22 Links | Identified witnesses". | Found from witnesses by J.W. Nichoson |
| | #3 - 36" Pine Stump N17°E 75 Links | #6 - 8" Walnut N61°E 70.50' |
| | #4 - 30" Pine Stump S59°W 103 1/4 Links | #7 - Power Pole S21°E 86.34' |
| | #5 - 24" Pine Stump S25 1/2°E | #4 - Pine Stump S60°30'W 69' |
| (See over for continuation of "A") | 104 1/2 Links | (found scribed "S14 BT") |
| | | "Developed plat of Deerpath Shores" |

B. Description of corner evidence found and/or method applied in restoring or reestablishing corner:

K-5 - Section corner common to Sections 11, 12, 13 & 14, T19N, R12W, Lake Co., Mi.

RATIFIED BY THE LAKE CO. PEER REVIEW GROUP
 IN ACCORDANCE WITH P.A. 345
 CHAIRMAN E.J.W.
 DATE 10-27-98

I found Blass's Timber Pin over top of 1-1/4" pipe in monument box at intersection of roads North, South, East and West. Fits well with recovered monuments from plat of "Alpine Village on Little Manistee".

Condition of the accessories are as follows: #1 Gone, #2 Gone, #3 Gone, #4 Found rotted stump, #5 Gone, #6 Found in good condition, #7 Found in good condition.

C. Description of monument for corner and accessories established to perpetuate locating the position of the corner:

K-5 - Section corner common to Sections 11, 12, 13 & 14, T19N, R12W, Lake Co., Mi.

I set a 3/4" x 24" re-bar with Lake County Brass Cap over top of the 1-1/4" pipe, and is accepted as a careful and faithful perpetuation of the position of the original corner

- 21" Walnut N63°E 70.34' (60d spike in N.W. side) #6
- Power Pole S18°E 86.30' (P.K. nail in E. side) #7
- 8" W. Pine S69°W 118.13' (60d spike in N. side)
- 25" Maple N69°W 112.45' (60d spike in S. side)

Signed by Robert L. Wetherell
 Surveyor's Michigan License No. 24624

Date 10-29-98

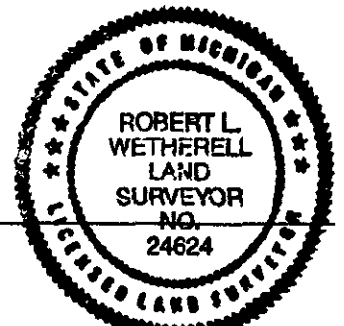

PLAT 2 3 1000

SECTION

CONTINUATION OF "A" - DESCRIPTION OF ORIGINAL MONUMENT AND ACCESSORIES AND/OR SUBSEQUENT RESTORATION:

1972 - Larry Gerschbacher, LS 18990

Developed plat of "Alpine Village on the Little Manistee".
No accessories given.

1981 & 1989 - R.L. Wetherell, LS 24624

Iron in monument box.
No accessories given.
Distance to 1/4 corner North - 2674.23'
Distance to 1/4 corner East - 2640.57'