

SURVEY & REMONUMENTATION

AUG 31 1999 LAND CORNER RECORDATION CERTIFICATE

FILING REQUIREMENT OF ACT 74, Mich. P.A. 1970

SECTION

RECORDED
LAKE COUNTY, MI
LIBER 004 PAGE 0204

JUL 23 3 04 PM '99

Christina H. Dechant
REGISTER OF DEEDS

For corners in Lake _____	Located in:	Corner Code#
1. Public Land Survey	T 20N R 11W	F-11
	T R	
	T R	
	T R	
2. Property Controlling s in Section	T R	
	S T R	
3. Miscellaneous Property in Sec.	S T R	
	S T R	
4. Lot No. _____ Recorded Plat		
5. Private Claims		

Register of Deeds Stamp & File Number

	A	B	C	D	E	F	G	H	I	J	K	L	M
1													
2	6	5	4	3	2	1							
3													
4	7	8	9	10	11	12							
5													
6	18	17	16	15	14	13							
7													
8	19	20	21	22	23	24							
9													
10	30	29	28	27	26	25							
11													
12	31	32	33	34	35	36							
13													

I, Robert L. Wetherell, in a field survey on June 2, 1999, do hereby certify that under requirements of P.A. 74, Michigan P.A. of 1970, the corner points mentioned in lines 1 and 2 above were in conformance with regulations and rules therefore as required in the current manual of survey instructions of the United States Department of the Interior, Bureau of Land Management or by decree of a Court of Law and/or that the corner points mentioned in lines 3, 4, and 5 above were in conformance with the rules of the Michigan Board of Land Surveyors or by a Decree Of a Court of Law; established, re-established, monumented, re-monumented, recovered, found as expressed below:

F-11 - 1/4 Corner common to Sections 28 & 33, T20N, R11W

A. Description of original monument and accessories and/or subsequent restoration:

1838 S. Sibley, G.L.O.
#1 - 10" Beech S27°W 32 Links
#2 - 10" Hemlock N8°E 12 Links

1919 - G. H. Johnson, Co. Sur.
#3 - 6" Apple S43°E 62'

1984 - C. Roser, LS 12028
L.C.R.C. - L. 03, Pg. 29
Found plow point
#4 - 4" R. Pine S40°E 54.24'
#5 - 7" B. Cherry S15°W 29.81'
#6 - P. Pole N10°E 51.89'
#7 - Cedar Post South 33'

1998 - R.L. Wetherell, LS 24624

Survey recorded L. 04, Pg. 294
#5 - 8" Cherry S15°W 29.65'
#6 - P. Pole N13°E 51.89'
#8 - 12" R. Pine S27°E 61.17'
#9 - 12" R. Pine N7°W 68.74'

NOTE: Witnesses for Gov't corners shown on Survey recorded in Liber 04, Pg. 294, are reversed.

B. Description of corner evidence found and/or method applied in restoring or reestablishing corner:

I found the old plow point with rotted wood stake in line with old fence to the South and tree line to North. Corner is 3 feet more or less South of centerline of East-West road.

Condition of the accessories are as follows: #1 Gone, #2 Gone, #3 Found 16" Stump, #4 Found Stump, #5 Found in good condition, #6 Found in good condition, #7 Found in good condition, #8 Found in good condition, #9, Found in good condition.

C. Description of monument for corner and accessories established to perpetuate locating the position of the corner:

I set 1 1/4" x 24" re-bar with Lake County Remon Cap directly over old plow point, and is accepted as a careful and faithful re-establishment of the position of the original corner.

8" Cherry S15°W 29.65' (60d nail in E. Side) #5
P. Pole N13°E 51.89 (P.K. nail in W. side) #6
12" R. Pine S27°E 61.17' (60d nail in N.E. side) #8
12" R. Pine N7°W 68.74' (60d nail in W. side) #9

ATIFIED BY THE LAKE CO. PEER REVIEW GROUP
IN ACCORDANCE WITH P.A. 345
CHAIRMAN *RJW*
DATE *7-20-99*

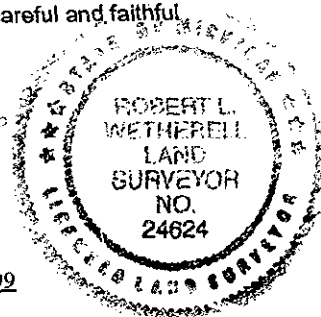

Signed by Robert L. Wetherell

Date July 21, 1999

Surveyor's Michigan License No. 24624