

DEC 3 9 1998

SECTION

LAND CORNER RECORDATION CERTIFICATE  
Filing Requirement of Act 74, Mich. P.A. 1970

LIBER 004 PAGE 0156

For corners in  
Lake

(County)	Located In:		Corner Code # I-11
	20N	11W	
1. Public Land Survey	T	R	
	T	R	
	T	R	
	T	R	
2. Property Controlling in Section	S	T	R
	S	T	R
3. Miscellaneous Property in Sec.	S	T	R
	S	T	R

REGISTERED  
LAKE COUNTY, MI.  
OCT 29 4 39 PM '98  
REGISTER OF DEEDS  
S. Sibley

Register of Deeds Stamp & File Number

4. Lot No. \_\_\_\_\_, Recorded Plat \_\_\_\_\_  
5. Private Claims \_\_\_\_\_

Robert L. Wetherell Aug. 3, 98

I, \_\_\_\_\_, in a field survey on \_\_\_\_\_, 19\_\_\_\_ do hereby state that under requirements of P.A. 74, Michigan P.A. of 1970, the corner points mentioned in lines 1 and 2 above were in conformance with regulations and rules therefore as required in the current manual of survey instructions of the United States Department of the Interior, Bureau of Land Management or by a decree of a Court of Law and /or that the corner points mentioned in lines 3, 4 and 5 above were in conformance with the rules of the Michigan Board of Land Surveyors or by a Decree of a Court of Law; established, re-established, monumented, recovered, found as expressed below:

NOTE: Not more than 2 corners, all in the same town and range, may be recorded on this certificate.

	A	B	C	D	E	F	G	H	I	J	K	L	M
1													
2	6		5		4		3		2		1		
3													
4	7		8		9		10		11		12		
5													
6	18		17		16		15		14		13		
7													
8	19		20		21		22		23		24		
9													
10	30		29		28		27		26		25		
11													
12	31		32		33		34		35		36		
13													

A. Description of original monument and accessories and/or subsequent restoration:

I-11 - Section corner common to Sections 26, 27, 34 & 35, T20N, R11W, Lake Co., Mi.

1838 - S. Sibley, G.L.O. .

#1 - 30" Hemlock

#2 - 8" Sugar N61°W 22 Links

Stream 30 Links wide South 8.8 Chains

1906 - J.W. Nicholson, Co. Sur.

"Old Corner identified positively"

#4 - 12" Sugar N61°W 22 Links

#5 - 8" Hemlock N86 1/2°E 36 Links

Set 1/16 corner North and

West of this corner.

RATIFIED BY THE LAKE CO. PEER REVIEW GROUP  
IN ACCORDANCE WITH P.A. 345

CHAIRMAN R.L.W.

DATE 10-27-98

B. Description of corner evidence found and/or method applied in restoring or reestablishing corner:

I-11 - Section corner common to Sections 26, 27, 34 & 35, T20N, R11W, Lake Co., Mi.

After a extensive search and dig, I was unable to recover a monument or any of the accessories mentioned above. This corner falls in a creek bottom over a 20 foot bank from roads North and East. This area has been used for a dump site for several years. I found the 1/16 corner (iron pipe) to the North. I set the corner by doubling over the distance (and line) from the East 1/4 corner Section 27 to the South 1/16 corner on the East line of Section 27. This position fits within 1 feet of a corner fence post I recovered at the 1/16 corner location to the West. Corner is 112 feet more or less North of the centerline of Coe Creek. Distance West to 1/4 corner is 2599.63 feet and distance North to the 1/4 corner is 2628.98 feet.

C. Description of monument for corner and accessories established to perpetuate locating the position of the corner:

I-11 - Section corner common to Sections 26, 27, 34 & 35, T20N, R11W, Lake Co., Mi.

I set a 3/4" x 24" re-bar with Lake County Brass Cap, and is accepted as a careful and faithful re-establishment of the position of the original corner.

17" Cherry N27°W 4.95' (60d spike in S.W. side)

14" Hemlock S22°W 42.92' (60d spike in E. side)

14" Maple N66°E 36.48' (60d spike in S.E. side)

6" Basswood N82°W 49.18' (60d spike in N. side)

Signed by Robert L. Wetherell

Date 10-29-98

Surveyor's Michigan License No. 24624

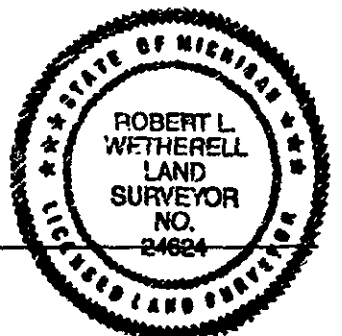

DEC 2 3 1883

SECTION 8

LIBER004 PAGE0157

CONTINUATION OF "A" - DESCRIPTION OF ORIGINAL MONUMENT AND ACCESSORIES AND/OR SUBSEQUENT RESTORATION:

1911 - G.H. Johnson, Co. Sur.

- #4 - 10" Birch S9°W 46 Links
- #5 - 8" Lynn N81 1/2°W 8 Links

1915 - G.H. Johnson, Co. Sur.

- 3/4" Pipe 4 feet long
- 10" Birch South 47 Links
- 18" Beech N22°E 27 Links
- 10" Elm N52°W 32 Links

1956 - W. Wright - Surveyor & Engineer

- Developed the plat of "Pine River Hills"
- No witnesses or monument given.
- Shows corner 112 feet North of creek.