

SURVEY &
REMONUMENTATION

1993

COMMISSION

REMONUMENTATION
LAND CORNER RECORDATION CERTIFICATE
Filing Requirement of Act 74, Mich. P.A. 1970

RECEIVED FOR RECORD

93 DEC 22 PM 2:41

LIBER NO. 5 FILE NO. 6
Shelby W. Money
REGISTERED PROFESSIONAL SURVEYOR
LAPEER COUNTY MICHIGAN

For corners in

LAPEER
(County)

Located In: Dryden Township Corner Code #

- | | | |
|---------------------------------------|--------------------------|-------------|
| 1. Public Land Survey | T <u>6N</u> R <u>11E</u> | <u>M-12</u> |
| | T _____ R _____ | _____ |
| | T _____ R _____ | _____ |
| | T _____ R _____ | _____ |
| 2. Property Controlling in Section | S _____ T _____ R _____ | _____ |
| | S _____ T _____ R _____ | _____ |
| 3. Miscellaneous Property in Sec. | S _____ T _____ R _____ | _____ |
| | S _____ T _____ R _____ | _____ |
| 4. Lot No. _____, Recorded Plat _____ | | |
| 5. Private Claims _____ | | |

Register of Deeds Stamp & File Number

	A	B	C	D	E	F	G	H	I	J	K	L	M
2	6		5		4		3		2		1		
3													
4	7		8		9		10		11		12		
5													
6	18		17		16		15		14		13		
7													
8	19		20		21		22		23		24		
9													
10	30		29		28		27		26		25		
11													
12	31		32		33		34		35		36		
13													

I, Shelby W. Money, in a field survey on September 13, 1993, do hereby certify that under requirements of P.A. 74, Michigan P.A. of 1970, the corner points mentioned in lines 1 and 2 above were in conformance with regulations and rules therefore as required in the current manual of survey instructions of the United States Department of the Interior, Bureau of Land Management or by a decree of a Court of Law and/or that the corner points mentioned in lines 3, 4 and 5 above were in conformance with the rules of the Michigan Board of Land Surveyors or by a Decree of a Court of Law; established, re-established, monumented, re-monumented, recovered, found as expressed below:

NOTE: Not more than 4 corners, all in the same town and range, may be recorded on this certificate.

A. Description of original monument and accessories and/or subsequent restoration:

POST G.L.O. NOTES / PAGE 347

L.C.R.C. LIBER 2 PAGE 667 (1974) BY KOBBS #14097

B. Description of corner evidence found and/or method applied in restoring or reestablishing corner:

FOUND 1/2" REBAR USING L.C.R.C LIBER 2 PAGE 667

FENCE LINE TO THE WEST

FOUND OAK TO SOUTHEAST 40.6'± TO CENTER (NO NAIL)

FOUND STUMP TO NORTHWEST 75'±

FOUND DOWN ANCHOR POST WITH STONES WEST 24'±

C. Description of monument for corner and accessories established to perpetuate locating the position of the corner:

SET LAPEER COUNTY REMONUMENTATION BRASS CAP MARKED #30092 / M-12 OVER EXISTING IRON

- WEST 60.01' NAIL WITH LAPEER COUNTY TAG IN SOUTH FACE OF UTILITY POLE
- N 45° W 26.54' NAIL WITH LAPEER COUNTY TAG IN NORTHEAST FACE OF 8" TWIN OAK
- N 15° E 154.93' NAIL WITH LAPEER COUNTY TAG IN WEST FACE OF UTILITY POLE
- N 40° E 43.60' NAIL WITH LAPEER COUNTY TAG IN NORTHWEST FACE OF 8" POPLAR
- S 30° E 40.63' NAIL WITH LAPEER COUNTY TAG IN SOUTHWEST FACE OF 21" OAK
- S 10° E 107.18' NAIL WITH LAPEER COUNTY TAG IN WEST FACE OF 15" CHERRY

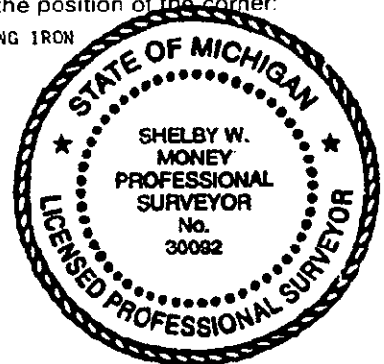

Signed by *Shelby W. Money*
Surveyor's Michigan License No. 30092

Date December 21, 1993