

# SURVEY & REMONUMENTATION

APR 28 1995

COMMISSION

## LAND CORNER RECORDATION CERTIFICATE Filing Requirement of Act 74, Mich. P.A. 1970

For corners in

<u>Lapeer</u> (County)	Located In: <u>Almont Township</u>	Corner Code # <u>H-2</u>
1. Public Land Survey	<u>T 6N R 12E</u>	<u>H-2</u>
	T <u>   </u> R <u>   </u>	<u>   </u>
	T <u>   </u> R <u>   </u>	<u>   </u>
	T <u>   </u> R <u>   </u>	<u>   </u>
2. Property Controlling in Section	S <u>   </u> T <u>   </u> R <u>   </u>	<u>   </u>
	S <u>   </u> T <u>   </u> R <u>   </u>	<u>   </u>
3. Miscellaneous Property in Sec.	S <u>   </u> T <u>   </u> R <u>   </u>	<u>   </u>
	S <u>   </u> T <u>   </u> R <u>   </u>	<u>   </u>

RECEIVED FOR RECORD

94 DEC 29 AM 10:16

LIBER NO. 65 PAGE NO. 191

REGISTER OF DEEDS  
LAPEER COUNTY MICHIGAN

Register of Deeds Stamp & File Number

4. Lot No. \_\_\_\_\_, Recorded Plat \_\_\_\_\_  
5. Private Claims \_\_\_\_\_

I, Shelby W. Money, in a field survey on 11-14, 19 94 do hereby certify that under requirements of P.A. 74, Michigan P.A. of 1970, the corner points mentioned in lines 1 and 2 above were in conformance with regulations and rules therefore as required in the current manual of survey instructions of the United States Department of the Interior, Bureau of Land Management or by a decree of a Court of Law and /or that the corner points mentioned in lines 3, 4 and 5 above were in conformance with the rules of the Michigan Board of Land Surveyors or by a Decree of a Court of Law; established, re-established, monumented, re-monumented, recovered, found as expressed below:

**NOTE: Not more than 4 corners, all in the same town and range, may be recorded on this certificate.**

A. Description of original monument and accessories and/or subsequent restoration:

- Joseph Wampler, D.S. in 1817 pages 556 - 560 set post. No witnesses left.
- Gilbert Bates 1865 pages 82 - 83 Stone 16" - 10" - 7".
- Unrecorded survey by Walter Lehner, P.S. 123 on 3-26-51 as an unknown.
- Survey recorded by Robert Kay, P.S. 14096 on 7-20-78 in liber 4, page 745, of surveys as an 1/2" iron.
- Survey recorded by Harold Elrich, P.S. 18986 on 10-23-79 in liber 5, page 545, of surveys as 3/8" iron. (Also found a 1/2" iron 0.7' South and 1.5' East).
- Survey recorded by Earel Gravlin, P.S. 23510 on 3-31-81 in liber 6, page 66, of surveys as a found 3/8" iron.
- Unrecorded survey by Charles Getz, P.S. 25843 on 11-17-82 as a found 3/8" iron.
- Survey recorded by Earl Gravlin P.S. 23510 on 12-13-78 in liber 5, page 102, of surveys as a found 1/2" iron bar.
- Survey recorded by Harold Elrich, P.S. 18986 on 7-9-873 in liber 7, page 610, of surveys as a found 1/2" iron bar.
- Survey recorded by Earl Gravlin, P.S. 23510 on 4-24-92 in liber 9, page 711, of surveys as a found 3/8" iron.
- Unrecorded survey by Ray Davis, P.S. 22430 on 2-27-94 as a found 1/2" rebar.

B. Description of corner evidence found and/or method applied in restoring or reestablishing corner:

Found a 5/8" rebar and a 3/8" rebar in the gravel road (Farley Road). the easterly 5/8" rebar appears to match the most history including the 1951 survey by Lehner. Fence line to the East and West. 3/8" iron is 0.6' North and 1.3' West of 5/8" iron. The two irons measure 1.40 feet between them.

Witnesses: from item 10 above  
 N 20° W 43.91' Rivet in North end 12" drive culvert  
 S 20° W 62.13' PK nail in 9" tree  
 East 37.12' Spike in 8" Tree.  
 West 34.45' Found capped iron  
 East 33.05' Found iron  
 Found 1/2" bar 0.60' North and 1.33' West.

Distances: East to I-2 2675.93' (Bates 2697.42)  
 West to G-2 2891.09' (Bates 2874.96)  
 North to H-2 3001.65' (Bates 2979.90)  
 South to H-3 2636.07' (Bates 2630.10)

C. Description of monument for corner and accessories established to perpetuate locating the position of the corner:

Removed 5/8" rebar and replaced with a 1/2" by 18" rebar and placed a standard Lapeer County Remonumentation cap stamped "H - 2 30092" at same location  
 Az 90° 37.12' Found PK, set nail with Lapeer County tag in South face of 8" Hickory.  
 Az 200° 62.10' Found PK, set nail with Lapeer County tag in East face 12" Poplar.  
 Az 330° 43.89' Found rivet at the North end of a 12" CMP culvert.  
 Az 350° 143.35' Set nail with Lapeer County tag in East face 26" Oak  
 East 33.05' Found 1/2" iron  
 West 34.50' Found 1/2" iron with cap # 23510.

Signed by Shelby W. Money  
 Surveyor's Michigan License No. 30092

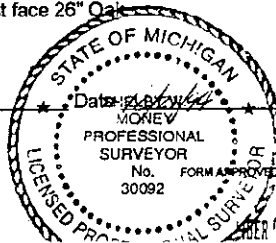

PEER GROUP  
 APPROVED LAND CORNER  
 PA 345 OF 1990  
 LAPEER COUNTY  
 RAY DAVIS P.S. CO. SURVEYOR  
 DATE 12-28-94

