

**SURVEY &
REMONUMENTATION**

APR 28 1995

COMMISSION

LAND CORNER RECORDATION CERTIFICATE
Filing Requirement of Act 74, Mich. P.A. 1970

For corners in
LAPEER
(County)

Located in: IMLAY TOWNSHIP Corner Code # A-6

1. Public Land Survey T 7N R 12E _____
T _____ R _____
T _____ R _____
T _____ R _____

2. Property Controlling in Section S _____ T _____ R _____
S _____ T _____ R _____
S _____ T _____ R _____

3. Miscellaneous Property in Sec. S _____ T _____ R _____

4. Lot No. _____, Recorded Plat _____

5. Private Claims _____

RECEIVED FOR RECORD
94 DEC -9 PM 3:20
LIBER NO. 5 PAGE NO. 146
Melrose De Young
REGISTER OF DEEDS
LAPEER COUNTY, MICHIGAN
Registrar of Deeds Stamp & File Number

I, SHELBY W. MONEY, in a field survey on SEPTEMBER 2, 1994 do hereby certify that under requirements of P.A. 74, Michigan P.A. of 1970, the corner points mentioned in lines 1 and 2 above were in conformance with regulations and rules therefore as required in the current manual of survey instructions of the United States Department of the Interior, Bureau of Land Management or by a decree of a Court of Law and for that the corner points mentioned in lines 3, 4 and 5 above were in conformance with the rules of the Michigan Board of Land Surveyors or by a Decree of a Court of Law; established, re-established, monumented, re-monumented, recovered, found as expressed below:

1	A	B	C	D	E	F	G	H	I	J	K	L	H
2	6	5	4	3	2	1							
3													
4	7	8	9	10	11	12							
5													
6	18	17	16	15	14	13							
7													
8	19	20	21	22	23	24							
9													
10	30	29	28	27	26	25							
11													
12	31	32	33	34	35	36							
13													

NOTE: Not more than 4 corners, all in the same town and range, may be recorded on this certificate.

A. Description of original monument and accessories and/or subsequent restoration:

- | | | | | | |
|------------|-----------------|----------|-------------------------------|-----------------------|--|
| 1) G.L.O. | NOT SET | | | | |
| 2) SURVEY | 1978 LIBER 004 | PAGE 733 | ROBERT G. KAY, #14096 | FOUND, 1" SQUARE IRON | |
| 3) LCRC | 1980 LIBER 003 | PAGE 586 | HAROLD N. ERLICH, #18986 | FOUND, 1" SQUARE IRON | |
| 4) SURVEY | 1980 LIBER 005 | PAGE 841 | HAROLD N. ERLICH, #18986 | FOUND, 1" SQUARE IRON | |
| 5) SURVEY | 1987 LIBER 007 | PAGE 755 | EARL E. GRAVLIN, #23510 | FOUND, UNKNOWN | |
| 6) SURVEY | 1988 LIBER 008 | PAGE 011 | EARL E. GRAVLIN, #23510 | FOUND, UNKNOWN | |
| 7) WITNESS | 1988 UNRECORDED | | LAPEER COUNTY ROAD COMMISSION | FOUND, 1" SQUARE IRON | |
| 8) SURVEY | 1989 LIBER 008 | PAGE 460 | EARL E. GRAVLIN, #23510 | FOUND, UNKNOWN | |
| 9) SURVEY | 1993 LIBER 010 | PAGE 248 | EARL E. GRAVLIN, #23510 | FOUND, UNKNOWN | |

B. Description of corner evidence found and/or method applied in restoring or reestablishing corner:

FOUND, 1" SQUARE IRON IN SEALCOAT ROAD
ATTICA ROAD TO THE WEST AND SUMMERS ROAD TO THE NORTH AND SOUTH

WITNESSES FOUND REFERENCING ITEMS 2, 3, 4, 5, 6, 7, 8 AND 9
S 80° E 75.65' FOUND, A NAIL IN A TELEPHONE POLE
S 70° W 35.38' FOUND, A NAIL IN A TELEPHONE PHONE POLE

G.L.O. OFFSET AT A-5, T.7N., R.12E. 44 LINKS 29.04'
G.L.O. OFFSET AT A-7, T.7N., R.12E. 32 LINKS 19.80'
A-6 TO A-5 T.7N., R.12E. G.L.O. {POST FOR A-6 NEVER SET} CHAINS MEASURED 2668.94'
A-6 TO A-7 T.7N., R.12E. G.L.O. {POST FOR A-6 NEVER SET} CHAINS MEASURED 2652.14'

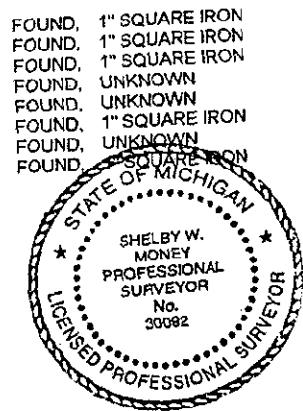

C. Description of monument for corner and accessories established to perpetuate locating the position of the corner:

SET, BRASS LAPEER COUNTY REMONUMENTATION CAP STAMPED #30092 / A-6 ON A 1/2" X 18" REBAR
IN A MONUMENT BOX SET BY THE LAPEER COUNTY ROAD COMMISSION

AZIMUTH 110° 76.18' SET, NAIL W/LAPEER TAG IN THE NORTH FACE OF UTILITY POLE
AZIMUTH 250° 33.93' SET, NAIL W/LAPEER TAG IN THE NORTH FACE OF UTILITY POLE AT HOUSE #47
AZIMUTH 290° 65.88' SET, NAIL W/LAPEER TAG IN THE SOUTH FACE OF UTILITY POLE AT HOUSE #47
AZIMUTH 315° 123.70' FOUND, THE NORTHEAST CORNER OF A HOUSE AT
STREET ADDRESS #47 NORTH SUMMERS ROAD

AZIMUTH 00° 19.60' FOUND, M-6, T.7N., R.11E. / ATTICA TOWNSHIP

PEER GROUP
APPROVED LAND CORNER
PA 345 OF 1990 Date December 2, 1994
SIGNED BY [Signature]
SURVEYOR'S MICHIGAN LICENSE NO. 30092
LAPEER COUNTY

RAY DAVIS, P.S. CO. SURVEYOR
DATE 12-9-94 LIBER 0005 PAGE 0146
FORM APPROVED BY MICHIGAN STATE BOARD OF LAND SURVEYORS, JAN. 28, 1971
REVISED MAY 14, 1975
REVISED JAN. 1993