

SURVEY & REMONUMENTATION

REMONUMENTATION

RECEIVED FOR RECORD

MAR 23 2000

LAND CORNER RECORDATION CERTIFICATE

00 FEB 10 PM 2:17

Filing Requirement of Act 74, Mich. P.A. 1970

SECTION

For corners in

Melissa De Vaughn
REGISTER OF DEEDS
LAPEER COUNTY, MICHIGAN

LAPEER Located In: OREGON TWP. Corner Code #
(County)

- | | | | |
|------------------------------------|--------------|--------------|-------------|
| 1. Public Land Survey | T <u>8</u> N | R <u>9</u> N | <u>E-13</u> |
| | T _____ | R _____ | _____ |
| | T _____ | R _____ | _____ |
| | T _____ | R _____ | _____ |
| 2. Property Controlling in Section | S _____ | T _____ | R _____ |
| | S _____ | T _____ | R _____ |
| 3. Miscellaneous Property in Sec. | S _____ | T _____ | R _____ |
| | S _____ | T _____ | R _____ |

479

Register of Deeds Stamp & File Number

4. Lot No. _____, Recorded Plat _____
5. Private Claims _____

	A	B	C	D	E	F	G	H	I	J	K	L	M
1													
2	6	5	4	3	2	1							
3													
4	7	8	9	10	11	12							
5													
6	18	17	16	15	14	13							
7													
8	19	20	21	22	23	24							
9													
10	30	29	28	27	26	25							
11													
12	31	32	33	34	35	36							
13													

I, MICHAEL G. HAY, in a field survey on AUGUST 22, 1999, do hereby certify that under requirements of P.A. 74, Michigan P.A. of 1970, the corner points mentioned in lines 1 and 2 above were in conformance with regulations and rules therefore as required in the current manual of survey instructions of the United States Department of the Interior, Bureau of Land Management or by a decree of a Court of Law and/or that the corner points mentioned in lines 3, 4 and 5 above were in conformance with the rules of the Michigan Board of Land Surveyors or by a Decree of a Court of Law; established, re-established, monumented, re-monumented, recovered, found as expressed below:

NOTE: Not more than 4 corners, all in the same town and range, may be recorded on this certificate.

- A. Description of original monument and accessories and/or subsequent restoration:
 1822- JOSEPH WAMPLER D.S. SET POST FOR SECTION 32 AND 33
 1978- ROBERT G. KAY P.S. 14096 (SURVEY) LIBER 4 PAGE 731 FOUND NAIL AND WASHER
 1988- LELAND D. BATES P.S. 16699 (SURVEY) LIBER 8 PAGE 169 FOUND 1/2" IRON
 1988- HAROLD N. ELRICH P.S. 18986 (SURVEY) LIBER 8 PAGE 172 FOUND 1/2" IRON
 1989- HAROLD N. ELRICH P.S. 18986 (SURVEY) LIBER 8, PAGE 589 REVISED (CORRECTION)
 1997- EARL E. GRAVLIN P.S. 23510 (SURVEY) LIBER 12 PAGE 360 FOUND 1/2" REROD
 1997- MICHAEL G. HAY P.S. 41101 (SURVEY) LIBER 12 PAGE 341 FOUND 1/2" IRON
 1998- MICHAEL G. HAY P.S. 41101 (SURVEY) LIBER 12 PAGES 572-573 FOUND 1/2" IRON IN MON BOX

PEER GROUP
APPROVED LAND CORNER
PA 345 OF 1990
LAPEER COUNTY
RAY DAVIS P.S. CO. SURVEYOR
DATE 12-2-1999

- B. Description of corner evidence found and/or method applied in restoring or reestablishing corner:
 1999- MICHAEL G. HAY P.S. 41101 FOUND 1/2" IRON IN MON BOX, FIVE FEET SOUTH OF CENTER LINE OF OREGON ROAD (PAVED) AND ON CENTER LINE INDIAN ROAD (PAVED) RUNNING NORTH.
 E-13 TO F-13 2624.44' (M) 2624.46' (GRAVLIN) 2640.00' (40 GLO)
 E-13 TO D-13 2639.94' (M) 2640.00' (HBE) 2640.11'(GRAVLIN) 2640.00' (GLO)
 E-13 TO E-1 (EAST) 110.65' (R&M) 114.18' (173 GLO)

- C. Description of monument for corner and accessories established to perpetuate locating the position of the corner:
 SET STANDARD REMONUMENTATION CAP ON 1/2" IRON IN MON BOX
 N 45 W 52.18' P.K. NAIL IN CONCRETE CURB
 S 30 W 31.30' P.K. NAIL AND TAG 23857 WEST FACE TWIN 8" MAPLE
 S 15 E 39.72' P.K. NAIL EAST FACE 12" POPLAR
 EAST 110.65' 1/2" IRON IN MON BOX

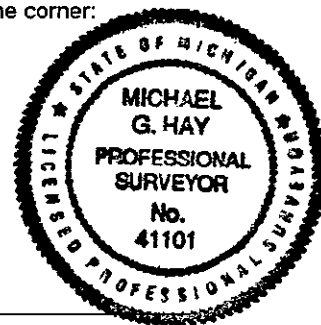

Signed by Michael G. Hay Date 1-11-2000
 Surveyor's Michigan License No. 41101

FORM APPROVED BY MICHIGAN STATE BOARD OF LAND SURVEYORS, JAN. 28, 1971