

SURVEY &  
REMONUMENTATION

1993

COMMISSION

REMONUMENTATION  
LAND CORNER RECORDATION CERTIFICATE

Filing Requirement of Act 74, Mich. P.A. 1970 RECEIVED FOR RECORD

For corners in

<u>LAPEER</u> (County)		Located In:	Corner Code #
		Arcadia	
1. Public Land Survey	T <u>8N</u> R <u>11E</u>		<u>M-10</u>
	T _____ R _____		_____
	T _____ R _____		_____
	T _____ R _____		_____
2. Property Controlling in Section	S _____ T _____ R _____		_____
	S _____ T _____ R _____		_____
3. Miscellaneous Property in Sec.	S _____ T _____ R _____		_____
	S _____ T _____ R _____		_____
4. Lot No. _____, Recorded Plat _____			
5. Private Claims _____			

94 JAN -5 PM 1: 22  
LIBER NO. 005 PAGE NO. 72  
*Melissa Miles*  
REGISTER OF DEEDS  
LAPEER COUNTY, MICHIGAN  
Register of Deeds Stamp & File Number

I, John C. Niederhauser, in a field survey on Nov. 4, 19 93, do hereby certify that under requirements of P.A. 74, Michigan P.A. of 1970, the corner points mentioned in lines 1 and 2 above were in conformance with regulations and rules therefore as required in the current manual of survey instructions of the United States Department of the Interior, Bureau of Land Management or by a decree of a Court of Law and/or that the corner points mentioned in lines 3, 4 and 5 above were in conformance with the rules of the Michigan Board of Land Surveyors or by a Decree of a Court of Law; established, re-established, monumented, re-monumented, recovered, found as expressed below:

**NOTE: Not more than 4 corners, all in the same town and range, may be recorded on this certificate.**

A	B	C	D	E	F	G	H	I	J	K	L	M
2	6	5	4	3	2	1						
3												
4	7	8	9	10	11	12						
5												
6	18	17	16	15	14	13						
7												
8	19	20	21	22	23	24						
9												
10	30	29	28	27	26	25						
11												
12	31	32	33	34	35	36						
13												

A. Description of original monument and accessories and/or subsequent restoration:

- Post (G.L.O. Notes, pg. 412)
- Beech 10" S 36 1/2 W 25'
- Sugar 16" N 71 W 50'

B. Description of corner evidence found and/or method applied in restoring or reestablishing corner:

- 1/2" rerod
- 2636.56' South to NE corner Section 36

C. Description of monument for corner and accessories established to perpetuate locating the position of the corner:

- Set brass disk stamped "Lapeer County Remonumentation M-10 #24608"
- SE to punch hole in N end 12" CSP 49.00'
- SW to punch hole in S end 12" CSP 59.40'
- W to nail w/remon. tag in S side fence post 34.78'
- NW to nail w remon. tag in NE face of twin 4" tree 43.26' *yen*

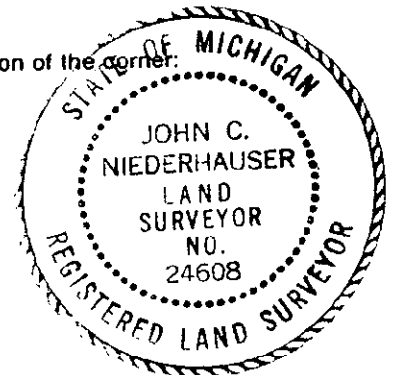

Signed by *John C. Niederhauser* Date Dec. 30, 1993

Surveyor's Michigan License No. 24608