

1993

COMMISSION

REMONUMENTATION  
LAND CORNER RECORDATION CERTIFICATE  
Filing Requirement of Act 74, Mich. P.A. 1970

RECEIVED FOR RECORD

For corners in

|                                       |                          |               |
|---------------------------------------|--------------------------|---------------|
| <u>LAPEER</u><br>(County)             | Located In:              | Corner Code # |
|                                       | Arcadia                  |               |
| 1. Public Land Survey                 | † <u>8N</u> † <u>11E</u> | <u>M-13</u>   |
|                                       | T _____ R _____          | _____         |
|                                       | T _____ R _____          | _____         |
|                                       | T _____ R _____          | _____         |
| 2. Property Controlling in Section    | S _____ T _____ R _____  | _____         |
|                                       | S _____ T _____ R _____  | _____         |
| 3. Miscellaneous Property in Sec.     | S _____ T _____ R _____  | _____         |
|                                       | S _____ T _____ R _____  | _____         |
| 4. Lot No. _____, Recorded Plat _____ |                          |               |
| 5. Private Claims _____               |                          |               |

94 JAN -5 PM 1:25  
LIBER NO. 005 FILE NO. 75  
Melissa Miles  
REGISTERED DEEDS  
LAPEER COUNTY MICHIGAN  
Register of Deeds Stamp & File Number

I, John C. Niederhauser, in a field survey on Nov. 4, 19 93, do hereby certify that under requirements of P.A. 74, Michigan P.A. of 1970, the corner points mentioned in lines 1 and 2 above were in conformance with regulations and rules therefore as required in the current manual of survey instructions of the United States Department of the Interior, Bureau of Land Management or by a decree of a Court of Law and/or that the corner points mentioned in lines 3, 4 and 5 above were in conformance with the rules of the Michigan Board of Land Surveyors or by a Decree of a Court of Law; established, re-established, monumented, re-monumented, recovered, found as expressed below:

| A  | B  | C  | D  | E  | F  | G  | H | I | J | K | L | M |
|----|----|----|----|----|----|----|---|---|---|---|---|---|
| 2  | 6  | 5  | 4  | 3  | 2  | 1  |   |   |   |   |   |   |
| 3  |    |    |    |    |    |    |   |   |   |   |   |   |
| 4  | 7  | 8  | 9  | 10 | 11 | 12 |   |   |   |   |   |   |
| 5  |    |    |    |    |    |    |   |   |   |   |   |   |
| 6  | 18 | 17 | 16 | 15 | 14 | 13 |   |   |   |   |   |   |
| 7  |    |    |    |    |    |    |   |   |   |   |   |   |
| 8  | 19 | 20 | 21 | 22 | 23 | 24 |   |   |   |   |   |   |
| 9  |    |    |    |    |    |    |   |   |   |   |   |   |
| 10 | 30 | 29 | 28 | 27 | 26 | 25 |   |   |   |   |   |   |
| 11 |    |    |    |    |    |    |   |   |   |   |   |   |
| 12 | 31 | 32 | 33 | 34 | 35 | 36 |   |   |   |   |   |   |
| 13 |    |    |    |    |    |    |   |   |   |   |   |   |

**NOTE: Not more than 4 corners, all in the same town and range, may be recorded on this certificate.**

A. Description of original monument and accessories and/or subsequent restoration:

Post (G.L.O. Notes, pg. 412)

B. Description of corner evidence found and/or method applied in restoring or reestablishing corner:

1/2" iron in mon. box  
S 31°E 60.30' to face of fence post  
S 30°W 54.40' (R) 53.90' (M) to face 30" oak  
2672.72' North to E 1/4 corner Section 36

C. Description of monument for corner and accessories established to perpetuate locating the position of the corner:

NW to nail w/remon. tag in E face twin 6" birch 114.96'  
NE to nail w/remon. tag in W face of 6" ash 129.88  
SW to nail w/remon. tag in E face of a 48" oak 54.52'  
SE to nail w/remon. tag in W face fence post 61.00'  
Set brass disk stamped "Lapeer County Remonumentation M-13 #24608"

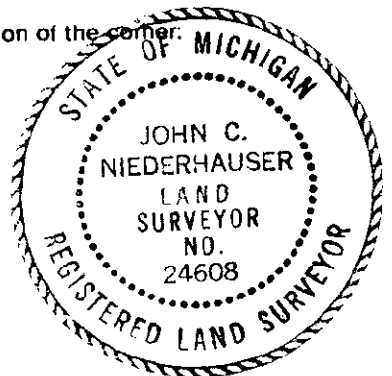

Signed by [Signature] Date Dec. 30, 1993

Surveyor's Michigan License No. 24608