

SURVEY & REMONUMENTATION

1993

COMMISSION

REMONUMENTATION
LAND CORNER RECORDATION CERTIFICATE
Filing Requirement of Act 74, Mich. P.A. 1970

RECEIVED FOR RECORD

For corners in

<u>Lapeer</u> (County)	Located In:	Corner Code #
	Goodland	
1. Public Land Survey	T <u>8N</u> R <u>12E</u>	<u>M-11</u>
	T _____ R _____	_____
	T _____ R _____	_____
	T _____ R _____	_____
2. Property Controlling in Section	S _____ T _____ R _____	_____
	S _____ T _____ R _____	_____
3. Miscellaneous Property in Sec.	S _____ T _____ R _____	_____
	S _____ T _____ R _____	_____
4. Lot No. _____, Recorded Plat _____		
5. Private Claims _____		

94 JAN -5 PM 1:27
LIBER NO. 005 PAGE NO. 77
Melissa Miles
REGISTERED DEEDS
LAPEER COUNTY MICHIGAN

Register of Deeds Stamp & File Number

I, John C. Niederhauser, in a field survey on Nov. 4, 1993, do hereby certify that under requirements of P.A. 74, Michigan P.A. of 1970, the corner points mentioned in lines 1 and 2 above were in conformance with regulations and rules therefore as required in the current manual of survey instructions of the United States Department of the Interior, Bureau of Land Management or by a decree of a Court of Law and/or that the corner points mentioned in lines 3, 4 and 5 above were in conformance with the rules of the Michigan Board of Land Surveyors or by a Decree of a Court of Law; established, re-established, monumented, re-monumented, recovered, found as expressed below:

	A	B	C	D	E	F	G	H	I	J	K	L	M
2	6		5						3			2	
3													
4	7		8		9		10		11			12	
5													
6	18		17		16		15		14			13	
7													
8	19		20		21		22		23			24	
9													
10	30		29		28		27		26			25	
11													
12	31		32		33		34		35			36	
13													

NOTE: Not more than 4 corners, all in the same town and range, may be recorded on this certificate.

A. Description of original monument and accessories and/or subsequent restoration:

Post (G.L.O. Notes) Set corner post common to Sections 25 & 36 (pg. 594)

B. Description of corner evidence found and/or method applied in restoring or reestablishing corner:

1/2" rerod slightly bent Referred to in 3/16/78 Road Commission notes
2673.24' North to E 1/4 corner Section 25
2642.54' South to E 1/4 corner Section 36

C. Description of monument for corner and accessories established to perpetuate locating the position of the corner:

Set brass disk stamped "Lapeer County Remonumentation M-11 #24608
S to 1/2" bar centerline Cade &
Centerline Road to east 84.72'
SE to nail w/remon. tag W face P. pole 134.46'
SW to nail w/remon. tag E face GTE pole 72.68'
NE to nail w/remon. tag W face P. pole 107.48'

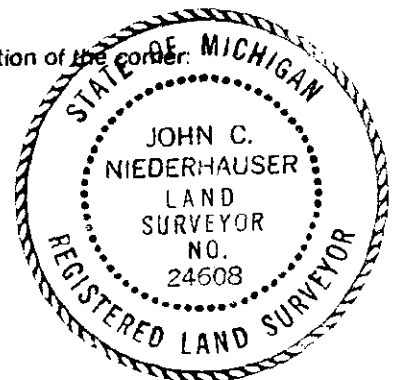

Signed by [Signature] Date Dec. 30, 1993

Surveyor's Michigan License No. 24608