

1993

COMMISSION

REMONUMENTATION LAND CORNER RECORDATION CERTIFICATE Filing Requirement of Act 74, Mich. P.A. 1970

For corners in

Form with fields for County (LAPEER), Located In (Goodland), Corner Code (# M-12), and numbered sections 1-5 for Public Land Survey, Property Controlling in Section, Miscellaneous Property in Sec., Lot No., and Private Claims.

RECEIVED FOR RECORD

94 JAN -5 PM 1:28

LIBER NO. 005 FILE NO. 78

Signature: Melissa Miles, REGISTERED SURVEYOR, LAPEER COUNTY, MICHIGAN

Register of Deeds Stamp & File Number

I, John C. Niederhauser, in a field survey on Nov. 4, 1993, do hereby certify that under requirements of P.A. 74, Michigan P.A. of 1970, the corner points mentioned in lines 1 and 2 above were in conformance with regulations and rules therefore as required in the current manual of survey instructions of the United States Department of the Interior, Bureau of Land Management or by a decree of a Court of Law and/or that the corner points mentioned in lines 3, 4 and 5 above were in conformance with the rules of the Michigan Board of Land Surveyors or by a Decree of a Court of Law; established, re-established, monumented, re-monumented, recovered, found as expressed below:

NOTE: Not more than 4 corners, all in the same town and range, may be recorded on this certificate.

Grid table with columns A-M and rows 2-13, containing numbers 1-36.

A. Description of original monument and accessories and/or subsequent restoration:

Post (G.L.O. Notes) 40 ch North of SE corner Section 36
40 ch South of SE corner Section 25

B. Description of corner evidence found and/or method applied in restoring or reestablishing corner:

1 1/2" pipe, good condition
2603.92' South to SE corner Section 36
2642.54' North to NE corner Section 36

C. Description of monument for corner and accessories established to perpetuate locating the position of the corner:

Set brass disk stamped "Lapeer County Remonumentation M-12 #24608"
SW to nail w/remon. tag in E side 7" elm 50.16'
WNW to nail w/remon. tag S side 12" stump 39.86'
E to nail w/remon. tag S side 4" elm 44.26'
NW to nail w/remon. tag E side 8" aspen 89.72'

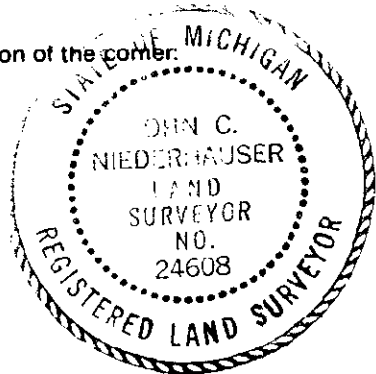

Signed by [Signature] Date Dec. 30, 1993

Surveyor's Michigan License No. 24608