

LAND CORNER RECORDATION CERTIFICATE
Filing Requirement of Act 74, Mich. P.A. 1970

For corners in LENAWEE COUNTY

(County)	Located In:	Corner Code #
1. Public Land Survey	T <u>5S</u> R <u>2E</u>	<u>A-4</u>
	T <u>5S</u> R <u>2E</u>	<u>B-4</u>
	T _____ R _____	_____
	T _____ R _____	_____
2. Property Controlling in Section	S _____ T _____ R _____	_____
	S _____ T _____ R _____	_____
3. Miscellaneous Property in Sec.	S _____ T _____ R _____	_____
	S _____ T _____ R _____	_____

Register of Deeds Stamp & File Number

4. Lot No. _____, Recorded Plat _____
 5. Private Claims _____

	A	B	C	D	E	F	G	H	I	J	K	L	M
2	6		5		4		3		2		1		
3													
4	7	8		9		10		11		12			
5													
6	18		17		16		15		14		13		
7													
8	19		20		21		22		23		24		
9													
10	30		29		28		27		26		25		
11													
12	31		32		33		34		35		36		
13													

I, Gary C. Bilow, in a field survey on March 21, 1991, do hereby certify that under requirements of P.A. 74, Michigan P.A. of 1970, the corner points mentioned in lines 1 and 2 above were in conformance with regulations and rules therefore as required in the current manual of survey instructions of the United States Department of the Interior, Bureau of Land Management or by a decree of a Court of Law and/or that the corner points mentioned in lines 3, 4 and 5 above were in conformance with the rules of the Michigan Board of Land Surveyors or by a Decree of a Court of Law; established, re-established, monumented, re-monumented, recovered, found as expressed below:

NOTE: Not more than 4 corners, all in the same town and range, may be recorded on this certificate.

A. Description of original monument and accessories and/or subsequent restoration:

A-4: Corner not established by original GLO survey. Michigan Department of Conservation Surveyor W. Lee Paddison established corner in Feb. 1959 as "set 1" iron with brass cap" - no accessories given. Corner recorded under Act 74, P.A. 1970 by Glenn Richard (RLS #13040) in Liber 1 page 83 as "found corner as described by Paddison on MICHIGAN DEPARTMENT of CONSERVATION SURVEY drawing (plan #E46A-1) - accessories: double headed nail in 4" twin oak, S60W, 5.37"; double headed nail in 6" oak, S20W, 16.87'."

B-4: Corner not established by original GLO survey. County Records dating back to the late 1800's call for an iron rod. Corner recorded under Act 74, P.A. 1970 by Glenn Richard (RLS #13040) in Liber 1 Page 79 as "found large spike over very old rusty pipe - accessories: MICHIGAN STATE HIGHWAY DEPARTMENT tag in RR tie post, N25W, 46.19'; MSHD tag in RR tie post, West, 22.53'; nail in 14" oak, N10W, 93.07'."

B. Description of corner evidence found and/or method applied in restoring or reestablishing corner:

A-4: Found Michigan Department of Conservation Monument with Brass Cap - no witnesses recovered. Accepted this corner as the West 1/4 corner of Section 7.

B-4: Found 1" pipe in the centerline of Brix Rd. and drove pipe to 6" depth - recovered two accessories. Accepted this corner as the Center 1/4 corner of Section 7.

C. Description of monument for corner and accessories established to perpetuate locating the position of the corner:

A-4: Found Michigan Department of Conservation Monument with Brass Cap
 S60W, 5.20', nail & Michigan Department of Natural Resources Tag in twin 10" Oak
 S16W, 17.24', nail & MDNR tag in 12" Oak
 S11E, 53.74', nail & MDNR tag in 8" Cherry
 N20W, 22.85', nail & MDNR tag in 12" Cherry

B-4: Found 1" pipe in centerline of Brix Road
 N25W, 46.24', nail & Michigan State Highway Department Tag in railroad tie post
 West, 22.63', nail & MSHD tag in railroad tie post
 N31E, 38.42', nail & Michigan Department of Natural Resources Tag in 10" Elm
 S17E, 78.85', nail & MDNR tag in 30" Oak

Signed by Gary C. Bilow Date 5/20/91
 Surveyor's Michigan License No. 26453

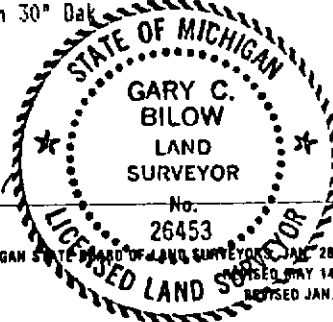

FORM APPROVED BY MICHIGAN STATE BOARD OF LAND SURVEYORS JAN 28, 1971
 REVISED MAY 14, 1975
 REVISED JAN., 1983