

OCT 19 1998

Filed under Remonumentation Act 345 of 1990
LAND CORNER RECORDATION CERTIFICATE
Filing Requirement of Act 74, Mich. P.A. 1970

STATE OF MICHIGAN
LENAWEE COUNTY
FILED

SECTION

For corners in

Table with columns: Lenawee (County), Located In: (Town/Range/Section), Corner Code #. Includes entries for Public Land Survey, Property Controlling in Section, and Miscellaneous Property in Sec.

15 SEP 1998 9:00:49 AM

VICTORIA J. DANIELS
REGISTER OF DEEDS

Register of Deeds Stamp & File Number

4. Lot No. Recorded Plat
5. Private Claims

Grid table with columns A-M and rows 1-13. Contains numbers 1-36 in a grid pattern.

I, Glenn E. Richard, in a field survey on July 29, 1998, do hereby certify that under requirements of P.A. 74, Michigan P.A. of 1970, the corner points mentioned in lines 1 and 2 above were in conformance with regulations and rules therefore as required in the current manual of survey instructions of the United States Department of the Interior, Bureau of Land Management or by a decree of a Court of Law and/or that the corner points mentioned in lines 3, 4 and 5 above were in conformance with the rules of the Michigan Board of Land Surveyors or by a Decree of a Court of Law; established, re-established, monumented, re-monumented, recovered, found as expressed below:

NOTE: Not more than 4 corners, all in the same town and range, may be recorded on this certificate.

A. Description of original monument and accessories and/or subsequent restoration:

- GLO 1819 Joseph Fletcher set post cor. Sec. 25 & 36 Lynn 7 N 66 W 9 Sycamore 40 S 26 W 20
1884 James Blair record called for tile over stake
1886 James Blair "Found stake and tile"
1891 James Blair found stake and tile under stone
1959 Kenneth Suydam (under direction of Walter E. Frazier RLS No. 2268) set a drag tooth in the pavement by using Blairs record distance from the north by checking the distance between the occupied fence lines at the 1/4 line and the 1/8 line 19.88 1/2 chains and doubling it South. He used the same method coming from the west.
1975 I found the drag tooth and recorded it in L 3 P 333
1980± Lenawee County Road Commission rebuilt the road and set a monument box
1997 Michael Bartolo found 3/4" iron pipe in monument box

B. Description of corner evidence found and/or method applied in restoring or reestablishing corner:

June 24, 1998 Found I.P. in monument box as recorded in L 3 P 333. Because the GLO record jog (78.54') between M-11 8-4 and A-11 8-5 didn't check I dug 2' south of the recorded corner and found a large red granite stone. I split the stone to look under it. I found pieces of tile and earthenware dishes. Couldn't find remains of wood stake. The peer group approved this location as the corner position. The corner established in 1959 and recorded in L 3 P 333 will be utilized as a property controlling corner for surveys tied to it.
July 29, 1998 Dug out the monument box at the location recorded in L3 P333 and set a 1/2" X 4' re-rod in the pavement for the property controlling corner. At the approved location, I set a 5/8" X 3' re-rod in a monument box with a Lenawee County Re-mon cap stamped P.S. 13040

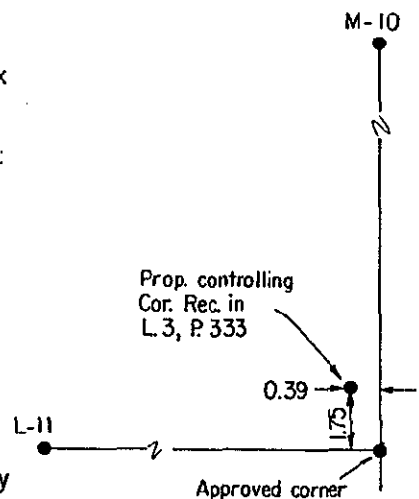

C. Description of monument for corner and accessories established to perpetuate locating the position of the corner:

- 5/8" X 3' re-rod in a monument box with a Lenawee County Re-mon cap stamped P.S. 13040 and is accepted as the best available evidence of the position of the original corner.
NE corner of house foundation S 50° W 117.97
NW corner of Garage foundation S 30° E 201.61
SW corner of house foundation N 75° E 108.97
SE corner of old store building N 45° W 48.16

A-10 T8S R5E South 78.54

Ratified by Peer Group in accordance with P.A. 345 Co. Rep. Glenn E. Richard Date July 21, 1998

Signed by Glenn E. Richard Date Aug 23, 1998
Glenn E. Richard

Surveyor's Michigan License No. 13040

