

**LAND CORNER RECORDATION CERTIFICATE**  
**Filing Requirement of Act 74, Mich. P.A. 1970 as Amended**

For corners in

<u>Luce</u> <small>(County)</small>	Located In:	Corner Code #	
1. Public Land Survey	T <u>    </u> R <u>    </u>		
	T <u>    </u> R <u>    </u>		
	T <u>    </u> R <u>    </u>		
2. Property Controlling in Section	S <u>    </u> T <u>    </u> R <u>    </u>		
	S <u>13</u> T <u>45N</u> R <u>8W</u>		<u>1</u>
	S <u>14</u> T <u>45N</u> R <u>8W</u>		<u>2</u>
3. Miscellaneous Property in Sec.	S <u>    </u> T <u>    </u> R <u>    </u>		
	S <u>    </u> T <u>    </u> R <u>    </u>		
4. Lot No. <u>    </u> , Recorded Plat <u>    </u>			
5. Private Claims			

Register of Deeds Stamp & File Number

A	B	C	D	E	F	G	H	I	J	K	L	M
1												
2	6	5	4	3	2	1						
3												
4	7	8	9	10	11	12						
5												
6	18	17	16	15	14	13						
7												
8	19	20	21	22	23	24						
9												
10	30	29	28	27	26	25						
11												
12	31	32	33	34	35	36						
13												

Jun 23 2003

I, Stephan J. Szyszkoski, in a field survey on     , 20     do hereby state that under requirements of P.A. 74, Michigan P.A. of 1970, the corner points mentioned in lines 1 and 2 above were in conformance with regulations and rules therefore as required in the current manual of survey instructions of the United States Department of the Interior, Bureau of Land Management or by a decree of a Court of Law and /or that the corner points mentioned in lines 3, 4 and 5 above were in conformance with the rules of the Michigan Board of Land Surveyors or by a Decree of a Court of Law; established, re-established, monumented, recovered, found as expressed below:

**NOTE: Not more than 2 corners, all in the same town and range, may be recorded on this certificate.**

A. Description of original monument and accessories and/or subsequent restoration:

- (1-Sec. 13) West 1/16 corner between Sections 12-13. Not established in the original survey.
- (2-Sec. 14) East 1/16 corner between Sections 11 and 14. Not established in the original survey.

B. Description of corner evidence found and/or method applied in restoring or reestablishing corner:

- (1-Sec. 13) Established the corner midway and on a line of mean true bearing between Section corner 1311.67' west and Quarter corner 1311.67' east. The corner falls 5 feet south of the centerline of State Hwy M-28. On Oct. 13, 2003, Michigan Dept. of Transportation personnel installed a monument box at this position and at the position for the corner drove a 5/8"x24" rebar with plastic cap "MICH DNR PS 33986"
- (2-Sec. 14) Established the corner midway and on a line of mean true bearing between Quarter corner 1325.61' west and Section corner 1325.61' east. The corner position falls in the M-28 ditch line 28.0' South of the physical centerline of Highway M-28.

C. Description of monument for corner and accessories established to perpetuate locating the position of the corner:

- |  |  |
|--|--|
| (1) Set 5/8"x24" rebar with yellow plastic cap "MICH DNR PS 33986" in monument box. Blazed, scribed, and set measuring nails in: | (2) Set a 1"IDx36" I.pipe with yellow plastic cap "MICH DNR PS33986" set flush. Blazed, scribed, and set measuring nails in: |
| 10" W.Pine S04E 29.85' "W1/16 BT"  | 10" Beech S24E 36.3' "E1/16 BT"  |
| 20" W.Pine S16W 42.6' do   | 12" Hemlock S27W 22.45' do   |
| 22" W.Pine S39E 47.55' do  | an Angle iron is S10W 25.85'   |
| 16" W.Pine N11W 105.75' do   | a Sign post is S82E 70.2'  |
| Bearings are magnetic. Distances are to nail with tag.   | Bearings are magnetic. Distances to trees are to nail with tag.  |

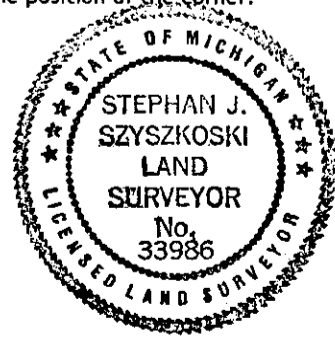

Signed by Stephan J. Szyszkoski  
 Surveyor's Michigan License No. 33986

Date 10/16/03

For the Michigan Department of Natural Resources, Office of Land and Facilities