

MICHIGAN
DEPARTMENT OF CONSERVATION
FORESTRY DIVISION

LAND CORNER RECORD

T. 45N N.R. 9-10W

Luce COUNTY

DESCRIPTION OF CORNER Sec. Cor. common to Secs. 19-30-24-25

CORNER MONUMENT 1" pipe with 4" brass cap

DATE MONUMENT PLACED AND WITNESSED 4-25-69

WITNESSES TO CORNER..... 8" Jack pine (S19 NBT) N63°E 27.9'

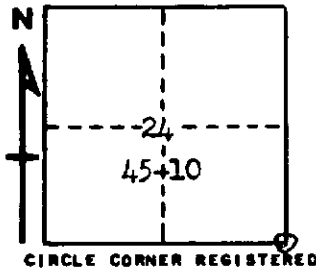

7" Red Pine (S25 NBT) S45°W 10.6'

7" Red Pine (S24 NBT) N43°W 14.8'

AND

DESCRIPTION IN DETAIL AS TO HOW CORNER WAS LOCATED AND IDENTIFIED OR RESTORED.

This corner re-established at record distance (4.25 chs) east of a probable line tree; a W. Pine stump in poor condition. Found no other 30" W. Pines near. This position agrees closely with Sec. Cors. one mile to north and one mile to south, being 6.0' east of a straight line and 2.9' north of mid-point.

Corner lies 45' S of trail road.

SURVEYOR'S SEAL

SIGNED Billy D. Buckler DATE 8-28-69
REGISTERED LAND SURVEYOR