

MICHIGAN
DEPARTMENT OF CONSERVATION
FORESTRY DIVISION



LAND CORNER RECORD

T. 45N N.R. 10W

Luce COUNTY

DESCRIPTION OF CORNER Sec. Cor. common to Secs. 20-21-28-29

CORNER MONUMENT 1" pipe with 4" aluminum Cap, buried in old, abandoned N.-S. Road

DATE MONUMENT PLACED AND WITNESSED 7-28-70

WITNESSES TO CORNER..... 7" Hard Maple (S28 NBT) S77°E 10.6'

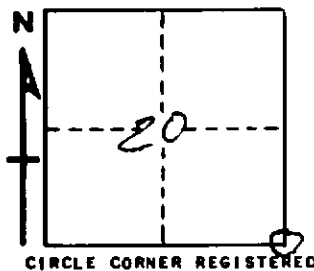

5" Hard Maple (S21 NBT) N18°E 34.5'

AND

DESCRIPTION IN DETAIL AS TO HOW CORNER WAS LOCATED AND IDENTIFIED OR RESTORED.

This corner re-established in an old N.-S. road and by single proportionate measure between Sec. Cor. one mile north and Sec. Cor. one mile south.
Found no evidence of original corner.

SURVEYOR'S SEAL

SIGNED Billy D. Buckler DATE 8-20-70
REGISTERED LAND SURVEYOR