

MICHIGAN
DEPARTMENT OF CONSERVATION
FORESTRY DIVISION

LAND CORNER RECORD

T. 45N N.R. 10W

Luce COUNTY

DESCRIPTION OF CORNER Sec. Cor. common to Secs. 28-29-32-33

CORNER MONUMENT 1" pipe with 4" aluminum Cap, buried in old, abandoned N.-S. Road

DATE MONUMENT PLACED AND WITNESSED 7-28-70

WITNESSES TO CORNER..... 9" B. Cherry (S28 NBT) N74°E 9.7'

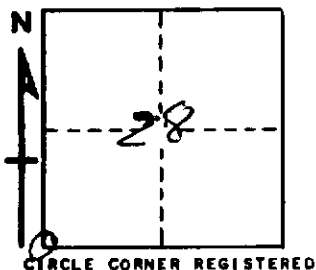

8" B. Cherry (S29 NBT) N66°W 53.1'

AND

DESCRIPTION IN DETAIL AS TO HOW CORNER WAS LOCATED AND IDENTIFIED OR RESTORED.

This corner re-established in old road and 20' east of an old fence corner. Found a blaze on tree facing this location. This position is 1.0' north of a point determined by proportionate measure, between corners; one mile south and two miles north. Found a brushed line bearing east, being 3.5' south of corner. Corner lies 126.0' east of present M-117 centerline.

SURVEYOR'S SEAL

SIGNED

Billy D. Buckler
Billy D. Buckler
REGISTERED LAND SURVEYOR

DATE 8-20-70