

MICHIGAN
DEPARTMENT OF CONSERVATION
FORESTRY DIVISION

LAND CORNER RECORD

T. 45 N. R. 10 ^{FILE 12-24-67}

_____ COUNTY

DESCRIPTION OF CORNER Section Corner corner to Sections 19-45-10-32

CORNER MONUMENT 1" pipe with 2" aluminum cap.

DATE MONUMENT PLACED AND WITNESSED 2/18/67

WITNESSES TO CORNER..... 7" tape rack (319 1-10) 112° 11.5'

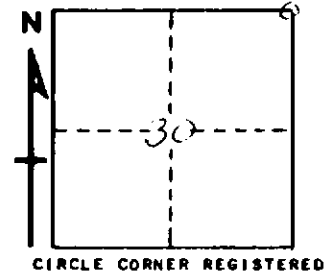

4" P. Gauge (329 1-10) 865° 21.0'

AND

DESCRIPTION IN DETAIL AS TO HOW CORNER WAS LOCATED AND IDENTIFIED OR RESTORED.

This corner replaced at a square of 4' x 4' iron pipe post, probably set by J. Lawrence, M.S.S.

Found no evidence of original location of any other corner.

Corner position fits road to north and other corners in the area.

Corner lies in 1/4 acre swamp.

Placed and witnessed with William Nettl, M.S.S.

SURVEYOR'S SEAL

SIGNED Billy D. Buckler DATE 2/18/67
REGISTERED LAND SURVEYOR