

MAY 28 1997

COMMISSION

LUCE COUNTY REMONUMENTATION CORNER

LAND CORNER RECORDATION CERTIFICATE  
Filing Requirement of Act 74, Mich. P.A. 1970

For corners in

Luce	Located In:	Corner Code #
(County)		
1. Public Land Survey	T 45NR 11W	✓ J-1
	T 46NR 11W	J-13
	T ___ R ___	
	T ___ R ___	
2. Property Controlling in Section	S ___ T ___ R ___	
	S ___ T ___ R ___	
3. Miscellaneous Property in Sec.	S ___ T ___ R ___	
	S ___ T ___ R ___	

LUCE COUNTY  
REGISTER OF DEEDS  
Recorded  
*Liber 2 Page 739*  
02-28-1997 09:59:22  
*Kathy S. Mahar*  
Kathy S. Mahar, Register  
REGISTER OF DEEDS

Register of Deeds Stamp & File Number

4. Lot No. \_\_\_\_\_, Recorded Plat \_\_\_\_\_  
5. Private Claims \_\_\_\_\_

I, William L. Karr, in a field survey on Dec. 5, 19 96 do hereby state that under requirements of P.A. 74, Michigan P.A. of 1970, the corner points mentioned in lines 1 and 2 above were in conformance with regulations and rules therefore as required in the current manual of survey instructions of the United States Department of the Interior, Bureau of Land Management or by a decree of a Court of Law and /or that the corner points mentioned in lines 3, 4 and 5 above were in conformance with the rules of the Michigan Board of Land Surveyors or by a Decree of a Court of Law; established, re-established, monumented, recovered, found as expressed below:

NOTE: Not more than 2 corners, all in the same town and range, may be recorded on this certificate.

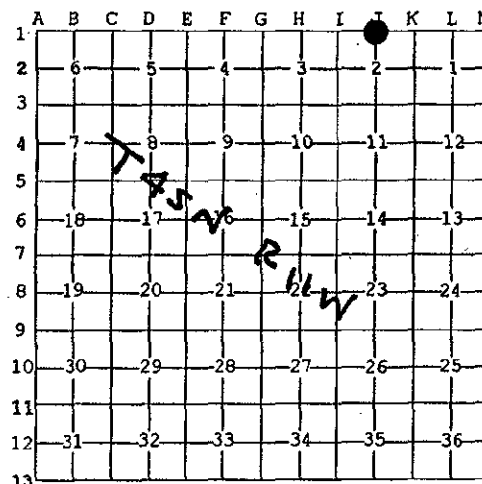

A. Description of original monument and accessories and/or subsequent restoration:

(J-1) 1/4 Corner Common to Section 2, T.45 N., R.11 W. and Section 35, T.46 N., R.11 W.  
1841: J. Burt for W.A. Burt set 1/4 Section post Tamarack 7 N36°E 61  
Tamarack 4 N51°W 45

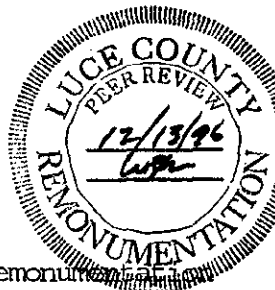

B. Description of corner evidence found and/or method applied in restoring or reestablishing corner:

(J-1) This Corner is being re-established as part of the Luce County Remonumentation Program.  
  
Found no evidence of original corner. Re-established the corner by single proportionate measurement between Section corners. Distance to the East is (2641.99') and distance to the West is (2641.98').

C. Description of monument for corner and accessories established to perpetuate locating the position of the corner:

(J-1) Corner is a 1/2" x 24" iron with stamped aluminum Luce County Remonumentation cap.

Witnesses:	10" Tamarack	N46°E	29.94'
	6" Spruce	S39°E	22.00'
	7" Spruce	S45°W	3.79'
	5" Tamarack	N47°W	8.07'

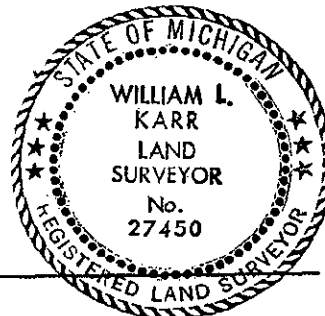

Signed by William L. Karr

Date 12-30-96

Surveyor's Michigan License No. 27450

NOTE: All bearings are compass bearings corrected for declination. All distances are to a nail in side of witness objects unless noted.