

MAR 13 2000

LAND CORNER RECORDATION CERTIFICATE FILING REQUIREMENT OF ACT 74, MICH. P.A. 1970 LUCE COUNTY REGISTER OF DEEDS

For corners in

Table with columns: Luce County, Located in:, Corner Code #. Rows include Public Land Survey, Property Controlling in Section, Miscellaneous Property in Sec., Lot No., and Private Claims.

Recorded Liber 3 Page 886 02-08-2000 08:28:43 Kathy S. Mahan Kathy S. Mahan, Register REGISTER OF DEEDS

Register of Deeds Stamp & File Number

Grid with columns A-M and rows 1-13. Handwritten 'T45N R12W' is written across the grid.

I, William L. Karr, in a field survey on November 11, 1999, do hereby state that under requirements of P.A. 74, Michigan P.A. of 1970, the corner points mentioned in lines 1 and 2 above were in conformance with regulations and rules therefore as required in the current manual of survey instructions of the United States Department of the Interior, Bureau of Land Management or by a decree of a Court of Law and/or that the corner points mentioned in lines 3, 4 and 5 above were in conformance with the rules of the Michigan Board of Land Surveyors or by a Decree of a Court of Law; established, re-established, monumented, recovered, found as expressed below:

NOTE: Not more than 2 corners, all in the same town and range, may be recorded on this certificate.

A. Description of original monument and accessories and/or subsequent restoration:

A-13 Township Corner Common to Section 31, Township 45 North, Range 12 West, Section 6, Township 44 North, Range 12 West, Section 1, Township 44 North, Range 13 West and Section 36, Township 45 North, Range 13 West.

- 1841 John Burt set post for the corner in original survey. Witnesses: Hemlock 9" S39°W 25 lks Cedar 14" N50°E 4 lks. 1987 Thomas O'Brien, P.S. 21274 recorded corner in Liber 2, Page 55 of Schoolcraft County Records. The corner was reestablished by double proportionate measurement between corners, 1/2 mile East, 1 1/2 miles West, 1/2 mile North and 1 mile South. Witnesses are 5" Spruce S26°W 9.55 feet, 5" Cedar S70°E 14.15 feet and 6" Spruce N27°W 13.30 feet.

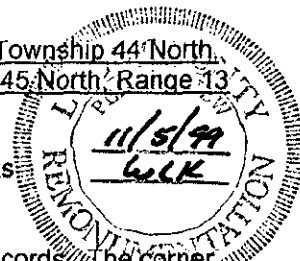

B. Description of corner evidence found and/or method applied in restoring or reestablishing corner:

A-13 Township Corner Common to Section 31, Township 45 North, Range 12 West, Section 6, Township 44 North, Range 12 West, Section 1, Township 44 North, Range 13 West and Section 36, Township 45 North, Range 13 West.

This corner is being perpetuated as part of the Luce County Remonumentation Program.

Found no evidence of original corner. Found 1" pipe with aluminum Schoolcraft County cap as recorded by O'Brien in 1987. Accepted corner position as found.

C. Description of monument for corner and accessories established to perpetuate locating the position of the corner:

A-13 Township Corner Common to Section 31, Township 45 North, Range 12 West, Section 6, Township 44 North, Range 12 West, Section 1, Township 44 North, Range 13 West and Section 36, Township 45 North, Range 13 West.

Corner is a 1" pipe with aluminum Schoolcraft County cap.

- Witnesses: Spruce 6" N38°E 7.66 feet Cedar 7" S76°E 14.17 feet (existing) Spruce 8" S19°W 9.57 feet (existing) Spruce 7" N34°W 13.26 feet (existing)



Bearings are compass bearings, corrected for declination (6° W), all distances are to a nail and tag in the side of the witness object unless otherwise noted.

Signed by William L. Karr

Date 12/29/99

Surveyor's Michigan License No.