

LAND CORNER RECORDATION CERTIFICATE
Filing Requirement of Act 74, Mich. P.A. 1970

For corners in

Luce	Located In:	Corner Code #	
(County)			
1. Public Land Survey	T <u>46</u> N R <u>9</u> W	<u>14</u>	
	T <u> </u> R <u> </u>	<u> </u>	
	T <u> </u> R <u> </u>	<u> </u>	
	T <u> </u> R <u> </u>	<u> </u>	
2. Property Controlling in Section	S <u> </u> T <u> </u> R <u> </u>	<u> </u>	
	S <u> </u> T <u> </u> R <u> </u>	<u> </u>	
3. Miscellaneous Property in Sec.	S <u> </u> T <u> </u> R <u> </u>	<u> </u>	
	S <u> </u> T <u> </u> R <u> </u>	<u> </u>	

Register of Deeds Stamp & File Number

4. Lot No. _____, Recorded Plat _____
 5. Private Claims _____

Mar 29 2005

I, Stephan J. Szyszkoski, in a field survey on _____, 19____ do hereby state that under requirements of P.A. 74, Michigan P.A. of 1970, the corner points mentioned in lines 1 and 2 above were in conformance with regulations and rules therefore as required in the current manual of survey instructions of the United States Department of the Interior, Bureau of Land Management or by a decree of a Court of Law and/or that the corner points mentioned in lines 3, 4 and 5 above were in conformance with the rules of the Michigan Board of Land Surveyors or by a Decree of a Court of Law; established, re-established, monumented, recovered, found as expressed below:

NOTE: Not more than 2 corners, all in the same town and range, may be recorded on this certificate.

	A	B	C	D	E	F	G	H	I	J	K	L	M
1													
2		6		5		4		3		2		1	
3													
4		7		8		9		10	●	11		12	
5													
6		10		17		16		15		14		13	
7													
8		19		20		21		22		23		24	
9													
10		30		29		28		27		26		25	
11													
12		31		32		33		34		35		36	
13													

A. Description of original monument and accessories and/or subsequent restoration:
 (14) Quarter corner common to Sections 10-11. 1850 - Established by Harvey Mellen, Deputy Surveyor: Corrected North between Sections 10 & 11 ... 40.15 Set post Qr. Section corner. Tamarac 6 S83E 12, Tamarac 6 N18W 7 ... 80.30 Section corner. 1972 - Reestablished by Billy D. Buckler RLS midway and on line between Section corners. Set 1" pipe with 4" aluminum cap. 8" Cedar S37E 35.3', 14" Cedar South 42.0'.

B. Description of corner evidence found and/or method applied in restoring or reestablishing corner:

(14) Recovered the 1972 monument in good condition and at record bearing and distance from the 1972 witnesses, both in good condition with overgrown blazes. I found this monument to be 9.4' East and 22.5' South of the midway position described in the 1972 record. A close examination of the field notes of the 1972 survey revealed that Mr. Buckler did not run a closed traverse between 13 and 15 and that I4 was run in from 15. Furthermore, my survey disclosed that the magnitude of these differences are not irregular when considering the 1972 survey. Consequently, I accept the monument as a careful and faithful reestablishment of the position of the original corner.

C. Description of monument for corner and accessories established to perpetuate locating the position of the corner:

(14) Found 1" ID I. pipe with 4" alum. MDNR cap. Set measuring nails in:
 12" Cedar S35E 35.55' mrkd "1/4S NBT" *
 13" Cedar S08W 41.95' do *
 14" Cedar S74E 68.5' do
 18" W. Pine N17E 64.3' do
 Bearings are magnetic. Distances are to nail with tag. * denotes 1972 NBT.

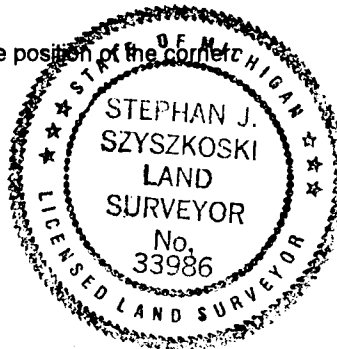

Signed by Stephan J. Szyszkoski
 Surveyor's Michigan License No. 33986

Date 6/22/05