

LAND CORNER RECORDATION CERTIFICATE
Filing Requirement of Act 74, Mich. P.A. 1970

For corners in

Luce

(County)

Located In:

Corner Code #

- | | | | | | | |
|------------------------------------|---|----|---|---|---|----|
| 1. Public Land Survey | T | 46 | R | 9 | W | 15 |
| | T | | R | | | |
| | T | | R | | | |
| | T | | R | | | |
| 2. Property Controlling in Section | S | | T | | R | |
| | S | | T | | R | |
| 3. Miscellaneous Property in Sec. | S | | T | | R | |
| | S | | T | | R | |

Register of Deeds Stamp & File Number

4. Lot No. _____, Recorded Plat _____
 5. Private Claims _____

Mar 24 2005

I, Stephan J. Szyszkoski, in a field survey on _____, 19____ do hereby state that under requirements of P.A. 74, Michigan P.A. of 1970, the corner points mentioned in lines 1 and 2 above were in conformance with regulations and rules therefore as required in the current manual of survey instructions of the United States Department of the Interior, Bureau of Land Management or by a decree of a Court of Law and /or that the corner points mentioned in lines 3, 4 and 5 above were in conformance with the rules of the Michigan Board of Land Surveyors or by a Decree of a Court of Law; established, re-established, monumented, recovered, found as expressed below:

NOTE: Not more than 2 corners, all in the same town and range, may be recorded on this certificate.

A	B	C	D	E	F	G	H	I	J	K	L	M
1												
2	6		5		4		3		2		1	
3												
4	7		8		9		10		11		12	
5								●				
6	10		17		16		15		14		13	
7												
8	19		20		21		22		23		24	
9												
10	30		29		28		27		26		25	
11												
12	31		32		33		34		35		36	
13												

A. Description of original monument and accessories and/or subsequent restoration:

(15) Corner common to Sections 10-11-14-15. 1850 - Established by Harvey Mellen, Deputy Surveyor: N89-59'W corrected between Sections 11 & 14 ...80.56 Set post corner of Sections 10,11,14,15. Spruce 5 N30E 21, W.Birch 7 S55W 19. 1972 - Reestablished by Billy D. Buckler RLS by single proportionate measure between corners to East and West. Found an old line of blazes to north of corner. Distance South (50 links) to swamp agrees. Set 1" pipe with 4" aluminum cap. 36" W.Pine S61W 37.3', 15" W.Pine S66E 42.7'.

B. Description of corner evidence found and/or method applied in restoring or reestablishing corner:

(15) Found the 1972 monument in good condition and at record bearing and distance from the 1972 accessories. The W.Pine SW is in good condition with overgrown blazes. The W.Pine SE is standing dead. Roughly verified the position of the corner by comparing its relationship to monuments at J5 and K5, and to the position of G5 as I recalculated it from the 1972 field notes. I found the position for this corner to be in substantial accord with the record and accepted same as a careful and faithful reestablishment of the position of the original corner.

C. Description of monument for corner and accessories established to perpetuate locating the position of the corner:

(15) Found 1" ID I.pipe with 4" alum. MDNR cap. Set measuring nails in:
 40" W.Pine S63W 39.65' mrkd "S15 NBT" *
 8" W.Birch S66E 28.9' "S14 NBT"
 6" B.Spruce S19E 12.2' do
 8" B.Spruce North 18.8' "S10 NBT"
 Bearings are magnetic. Distances are to nail with tag. * denotes 1972 NBT.

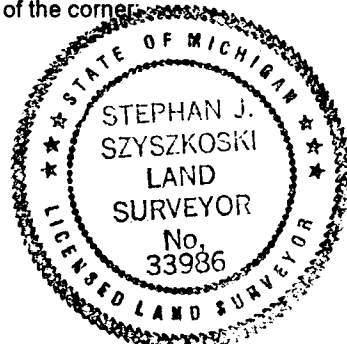

Signed by Stephan J. Szyszkoski
 Surveyor's Michigan License No. 33986

Date 6/22/05