

**LAND CORNER RECORDATION CERTIFICATE**  
**Filing Requirement of Act 74, Mich. P.A. 1970**

For corners in

Luce	Located In:	Corner Code #	
_____ (County)			
1. Public Land Survey	T 46N R 9W	K1	_____
	T _____	R _____	_____
	T _____	R _____	_____
	T _____	R _____	_____
2. Property Controlling in Section	S _____	T _____	R _____
	S _____	T _____	R _____
3. Miscellaneous Property in Sec.	S _____	T _____	R _____
	S _____	T _____	R _____

Register of Deeds Stamp & File Number

4. Lot No. \_\_\_\_\_, Recorded Plat \_\_\_\_\_  
 5. Private Claims \_\_\_\_\_

Mar 21 2005

I, Stephan J. Szyszkoski, in a field survey on \_\_\_\_\_, 19\_\_\_\_ do hereby state that under requirements of P.A. 74, Michigan P.A. of 1970, the corner points mentioned in lines 1 and 2 above were in conformance with regulations and rules therefore as required in the current manual of survey instructions of the United States Department of the Interior, Bureau of Land Management or by a decree of a Court of Law and /or that the corner points mentioned in lines 3, 4 and 5 above were in conformance with the rules of the Michigan Board of Land Surveyors or by a Decree of a Court of Law; established, re-established, monumented, recovered, found as expressed below:

**NOTE: Not more than 2 corners, all in the same town and range, may be recorded on this certificate.**

	A	B	C	D	E	F	G	H	I	J	K	L	M
1													
2	6		5		4		3		2		1		
3													
4	7		8		9		10		11		12		
5													
6	10		17		16		15		14		13		
7													
8	19		20		21		22		23		24		
9													
10	30		29		28		27		26		25		
11													
12	31		32		33		34		35		36		
13													

**A. Description of original monument and accessories and/or subsequent restoration:**

(K1) Corner common to Sections 1-2 T46N-R9W and Sections 35-36 T47N-R9W. 1840 or 1841 - Established by Wm. Burt, Deputy Surveyor: West on South side of Section 36 ... 80.00 Set post corner of sections 35 & 36. B.Ash N24E 20, B.Ash 12 N14W 23. 1850 - Additional BTs by Harvey Mellen, Deputy Surveyor: Cedar 12 S35W 30 links, B.Ash S41E 17 links. 1961 - Remonumented by Billy D. Buckler RLS: This corner was replaced from scribed post with NBTs rewitnessed by H.Lawrence. Trace of B.Ash stump BT to NW. Set 1" iron pipe with 4" brass cap. 10" W.Birch S38W 33 links, 8" Tamarack N21W 31.5 links. NBTs by H.Lawrence, Registered Surveyor: 8" S.Maple S20W 12.5 links, 7" Tamarack N87W 26.5 links.

**B. Description of corner evidence found and/or method applied in restoring or reestablishing corner:**

(K1) Found the 1961 monument in good condition and at record bearing and distance from the 1961 witnesses of record. The W.Birch NW and the 8" Tamarack N21W are now stumps. The Lawrence NBTs Maple SW and 7" Tamarack N87W are in good condition with overgrown blazes. Accepted the monument as a careful and faithful perpetuation of the position of the original corner.

**C. Description of monument for corner and accessories established to perpetuate locating the position of the corner:**

(K1) Found 1" ID I.pipe with 4" brass Dept. of Conservation tablet. Set measuring nails in:  
 11" Maple S28W 8.4' mrkd "S2" \*  
 10" Tamarack N78W 17.65' "S35" \*  
 6" B.Spruce S43W 12.2' mrkd "S2 NBT"  
 9" Cedar S70E 11.3' "S1 NBT"  
 Bearings are magnetic. Distances are to nail with tag. \* denotes 1961 NBT.

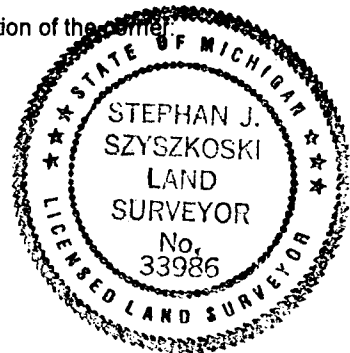

Signed by Stephan J. Szyszkoski  
 Surveyor's Michigan License No. 33986

Date 6/22/05