

SURVEY & REMONUMENTATION

APR 07 1998 LAND CORNER RECORDATION CERTIFICATE
Filing Requirement of Act 74, Mich. P.A. 1970

For corners in **SECTION**

Luce County Located in: Corner Code #

1. Public Land Survey	T46N R10W I-4
	T R
	T R
	T R
2. Property Controlling in Section	S T R
	S T R
3. Miscellaneous Property in Sec.	S T R
	S T R

4. Lot No. , Recorded Plat .
 5. Private Claims

LUCE COUNTY
 REGISTER OF DEEDS
 Recorded
Liber 3 Page 802
 03-06-1998 10:47:17
Deborah Johnson Sep.
 Katha S. Mahar, Register
 REGISTER OF DEEDS

Register of Deeds Stamp & File Number

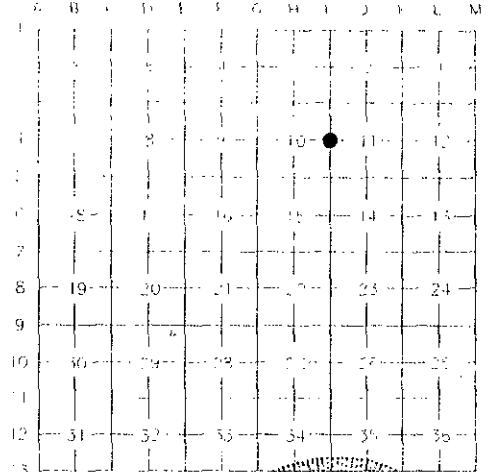

I, Keith R. Waters, in a field survey on November 25, 1997, do hereby state that under requirements of P.A. 74, Michigan P.A. of 1970, the corner points mentioned in lines 1 and 2 above were in conformance with regulations and rules therefore as required in the current manual of survey instructions of the United States Department of the Interior, Bureau of Land Management or by a decree of a Court of Law and /or that the corner points mentioned in lines 3, 4 and 5 above were in conformance with the rules of the Michigan Board of Land Surveyors or by a Decree of a Court of Law; established, re-established, monumented, recovered, found as expressed below:

NOTE: Not more than 2 corners, all in the same town and range, may be recorded on this certificate.

A. Description of original monument and accessories and/or subsequent restoration:

I-4 1/4 Corner common to Sections 10 & 11, Town 46 North, Range 10 West

- 1853 - Original corner was established by George H. Cannon, D.S.
 Witnesses: Maple 9, N25°W 14 links - Maple 12, S43°E 10 links
- 1963 - Notes from DNR Surveyor Billy D. Buckler, RLS 8887, state that the north 1/2 mile between sections 10 and 11 is 40.74 chains. This appears to simply be a measurement between road centerlines.
- 1979 - Sketch by Billy Buckler shows that he used the center of road for 1/4 corner location and set south 1/16 corner between sections 10 and 11 based on this position. Distance on the south 1/2 mile is shown as 40.00 chains.
- 1980 - Sketch by Billy Buckler shows that he believes that the 1/4 corner should be north of the road. This appears to be based on the assumption of section corner I-3 being in the center of the road, and splitting the distance between I-3 and I-5.

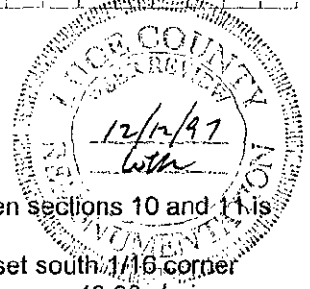

B. Description of corner evidence found and/or method applied in restoring or reestablishing corner:

This corner is being reestablished as part of the Luce County Remonumentation Program. Found no evidence of the original corner monument or its accessories. Reestablished corner by single proportionate measurement midway on line between section corners I-3 and I-5 2634.2 feet north and south. This position falls approximately 5 feet south of the centerline of County Road 446 and is on the extension of an old fence line to the north. Based on other work in this area, I do not believe that road centerlines can be used as evidence of the original corner locations and did not use the roads to establish corners at either I-3 or I-4 as noted in above mentioned DNR notes. The distance between I-1 and I-5 is within 24 feet of the original GLO distance in two plus miles, using the roads to establish the corners would result in large discrepancies with GLO and also create very unequal 1/2 mile distances for this two mile stretch.

C. Description of monument for corner and accessories established to perpetuate locating the position of the corner:

Placed a 1/2" rebar with a plastic cap #33142 at the corner location, which falls 5 feet south of the centerline of County Road 446, on the extension of an old fence line to the north. Witnesses:

- Power Pole, S24°W 29.94'
- 16" Red Pine, N61°E 94.48'
- 16" Spruce, N13°E 85.20'
- 20" Spruce, N22°W 57.68'

Note: Distances are to a nail/tag #33142 in the side of the witness object. Bearings are compass bearings corrected for declination.



Signed by Keith R. Waters

Date 12-30-97

Surveyor's Michigan License No. 33142