

LAND CORNER RECORDATION CERTIFICATE
Filing Requirement of Act 74, Mich. P.A. 1970

For corners in

<u>Luce</u> (County)	Located In:	Corner Code #
1. Public Land Survey	T <u>46N</u> R <u>11W</u>	<u>61</u>
	T <u> </u> R <u> </u>	<u> </u>
	T <u> </u> R <u> </u>	<u> </u>
	T <u> </u> R <u> </u>	<u> </u>
2. Property Controlling in Section	S <u> </u> T <u> </u> R <u> </u>	<u> </u>
	S <u> </u> T <u> </u> R <u> </u>	<u> </u>
3. Miscellaneous Property in Sec.	S <u> </u> T <u> </u> R <u> </u>	<u> </u>
	S <u> </u> T <u> </u> R <u> </u>	<u> </u>

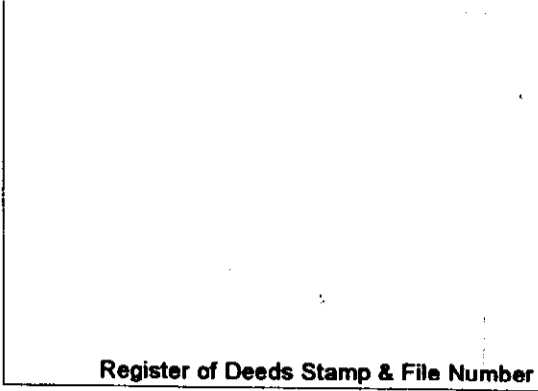

4. Lot No. _____, Recorded Plat _____
 5. Private Claims _____

Sep 18 2002

I, Stephan J. Szyszkoski, in a field survey on _____, 20____ do hereby state that under requirements of P.A. 74, Michigan P.A. of 1970, the corner points mentioned in lines 1 and 2 above were in conformance with regulations and rules therefore as required in the current manual of survey instructions of the United States Department of the Interior, Bureau of Land Management or by a decree of a Court of Law and/or that the corner points mentioned in lines 3, 4 and 5 above were in conformance with the rules of the Michigan Board of Land Surveyors or by a Decree of a Court of Law; established, re-established, monumented, recovered, found as expressed below:

NOTE: Not more than 2 corners, all in the same town and range, may be recorded on this certificate.

	A	B	C	D	E	F	G	H	I	J	K	L	M
1													
2		6		5		4		3		2		1	
3													
4		7		8		9		10		11		12	
5													
6		18		17		16		15		14		13	
7													
8		19		20		21		22		23		24	
9													
10		30		29		28		27		26		25	
11													
12		31		32		33		34		35		36	
13													

A. Description of original monument and accessories and/or subsequent restoration:

(G1) Corner common to Sections 3-4 T46N-R11W and 33-34 T47N-R11W. 1841-Established by John Burt for Wm. A. Burt: West on South side Sec. 34...80.00 Set post corner of Sections 33 & 34. Birch 10 N55E 22, Birch 12 N24W 43. 1851-Additional accessories by Francis Colman: Y. Birch 14 S50E 22, W.Pine 36 S44W 42. 1960-Remonumented by Billy D. Buckler RLS: This corner was replaced from probable B.T. bearing S34W 41 links. Found possible traces of stake in soil. Checked south to Hemlock line tree and Section corner. Position checks with corners to east and west along township line. Corner lies 1 1/4 chains north of road. Mr. Buckler set a 1" pipe with 4" brass cap at the corner and made witnesses 15" W. Pine S04E 229 links, W.Pine Stump S34W 41 links (the OBT).

B. Description of corner evidence found and/or method applied in restoring or reestablishing corner:

(G1) Found the 1960 monument as described, with a MI Dept. of Conservation cap, in good condition, and at substantial record bearing and distance from the 15" W.Pine NBT, now dead but standing, and the remains of the W.Pine Stump S34W 41 links, no markings visible. Course east (S 89deg. 56'E 120.30 M, East 120.0 R) and south (S 57'E 79.93 M, S 57'E 79.46 R) check well with the record. I accept the monument and make new witnesses as described below.

C. Description of monument for corner and accessories established to perpetuate locating the position of the corner:

(G1) Found 1" ID I.pipe with 4" brass MI Dept. of Conservation cap. Blazed, scribed and set measuring nails in:
 10" R.Pine S24W 52.85' "S4 NBT"
 6" W.Pine N29W 46.65' "S33 NBT"
 4" W.Pine N39E 34.8' "S34 NBT"
 14" R.Pine S63E 20.2' "S3 NBT"
 Bearings are magnetic. Distances are to nail with tag.

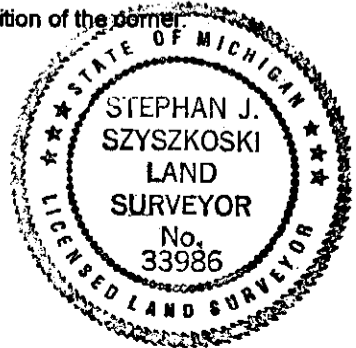

Signed by Stephan J. Szyszkoski
 Surveyor's Michigan License No. 33986

Date 12/10/02