

MICHIGAN
DEPARTMENT OF CONSERVATION
FORESTRY DIVISION



LAND CORNER RECORD

T. 47 N.R. 8 & 9 W

Luce COUNTY

DESCRIPTION OF CORNER 1/4 Corner between Secs. 13, T47N R9W and 18 T47N R3W

CORNER MONUMENT 1" Iron Pipe with 4" Aluminum Cap

DATE MONUMENT PLACED AND WITNESSED 4/1/64 with Forestry Aide Kubick and R. Hinds

WITNESSES TO CORNER..... 9" Cedar (1/2 S NBT) N58°E, 68 Lks.

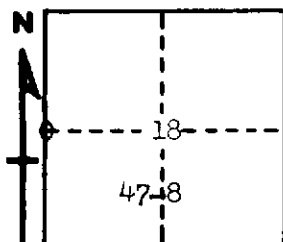

9" Cedar (1/2 S NBT) N55°W, 77 Lks.

AND

CIRCLE CORNER REGISTERED

DESCRIPTION IN DETAIL AS TO HOW CORNER WAS LOCATED AND IDENTIFIED OR RESTORED.

This Corner was replaced from scribed post.

SURVEYOR'S SEAL

SIGNED Frank J. Bray DATE 8/17/1964
REGISTERED LAND SURVEYOR