

MICHIGAN
DEPARTMENT OF CONSERVATION
FORESTRY DIVISION

LAND CORNER RECORD

T. 48 N. R. 8-9

Luce COUNTY

DESCRIPTION OF CORNER 1/4 Corner Between Sections 19-24

CORNER MONUMENT 1" Pipe with 4" Aluminum Cap.

DATE MONUMENT PLACED AND WITNESSED 9/19/67

WITNESSES TO CORNER..... 9" Hard Maple (1/4S NBT) N28°E 11.5'

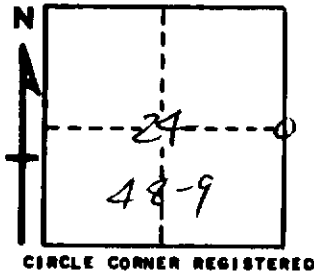

8" Soft Maple " N50°W 8.0'

AND

DESCRIPTION IN DETAIL AS TO HOW CORNER WAS LOCATED AND IDENTIFIED OR RESTORED.

This corner replaced at an old scribed post; a 1/2" Iron pipe and an angle iron, as set by unknown persons. Found evidence of original witnesses.

Corner lies 1 chain North of a woods road.

Placed and witnessed with L. Rubick, Forestry Aide.

SURVEYOR'S SEAL

SIGNED Billy D. Buckler
Billy D. Buckler
REGISTERED LAND SURVEYOR DATE 10/26/67