

MICHIGAN
DEPARTMENT OF CONSERVATION
FORESTRY DIVISION

LAND CORNER RECORD

T. 48-49 N.R. 9W

Luce COUNTY

DESCRIPTION OF CORNER Sec. Cor. common to Secs. 4-5-32-33

CORNER MONUMENT 1" pipe with 4" aluminum cap.

DATE MONUMENT PLACED AND WITNESSED 7/10/68

WITNESSES TO CORNER..... 9" Cedar (S4 NBT) S51°E 14.1'

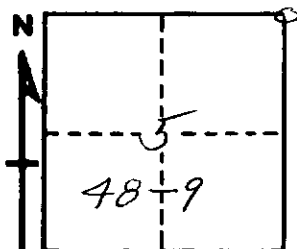

8" Soft Maple (S32 NBT) N34°W 25.3'

AND

CIRCLE CORNER REGISTERED

DESCRIPTION IN DETAIL AS TO HOW CORNER WAS LOCATED AND IDENTIFIED OR RESTORED.

This corner replaced as set by H. Lawrence R.L.S.
Found iron fence post and a scribed cedar post in
place.

Found numerous blazes but could not identify the
original witnesses.

SURVEYOR'S SEAL

SIGNED Billy D. Buckler
Billy D. Buckler, R.L.S. DATE 9/13/68
REGISTERED LAND SURVEYOR