

LAND CORNER RECORDATION CERTIFICATE
Filing Requirement of Act 74, Mich. P.A. 1970

For corners in
Luce

(County)	Located In:	Corner Code #
1. Public Land Survey	T <u>48N</u> R <u>10W</u>	<u>C11</u>
	T _____ R _____	_____
	T _____ R _____	_____
	T _____ R _____	_____
2. Property Controlling in Section	S <u>32</u> T <u>48N</u> R <u>10W</u>	<u>1</u>
	S _____ T _____ R _____	_____
3. Miscellaneous Property in Sec.	S _____ T _____ R _____	_____
	S _____ T _____ R _____	_____

Register of Deeds Stamp & File Number

4. Lot No. _____, Recorded Plat _____
 5. Private Claims _____

Jan 27 2005

I, Stephan J. Szyszkoski, in a field survey on _____, 19____ do hereby state that under requirements of P.A. 74, Michigan P.A. of 1970, the corner points mentioned in lines 1 and 2 above were in conformance with regulations and rules therefore as required in the current manual of survey instructions of the United States Department of the Interior, Bureau of Land Management or by a decree of a Court of Law and/or that the corner points mentioned in lines 3, 4 and 5 above were in conformance with the rules of the Michigan Board of Land Surveyors or by a Decree of a Court of Law; established, re-established, monumented, recovered, found as expressed below:

NOTE: Not more than 2 corners, all in the same town and range, may be recorded on this certificate.

1	A	B	C	D	E	F	G	H	I	J	K	L	M
2		6	5		4		3		2		1		
3													
4		7	8		9		10		11		12		
5													
6		18	17		16		15		14		13		
7													
8		19	20		21		22		23		24		
9													
10		30	29		28		27		26		25		
11			•	•									
12		31	32		33		34		35		36		
13													

A. Description of original monument and accessories and/or subsequent restoration:
 (C11) Corner common to Sections 29-30-31-32. 1974 - Reestablished by Billy D. Buckler RLS "using an original Line Tree and 1/4 Cor. to East. Position checks well with corners 1 mile North and 1 mile South". Set 1" pipe with 4" aluminum cap. 6" B. Spruce S33W 30.8', 10" W. Birch N25W 15.2'.
 (1-Sec. 32) West 1/16 corner between Sections 29 and 32. Not established in the original survey.

B. Description of corner evidence found and/or method applied in restoring or reestablishing corner:

(C11) Recovered the 1974 monument in good condition and at record bearing and distance from the W. Birch NBT, now 12" DBH and in good condition. The B. Spruce NBT was not recovered. Measured distances to reestablished Section corner 5280.5' south (5297.8 GLO) and perpetuated original Quarter corner 2653.0' east (2652.5' GLO) and found them to check reasonably with the record. Accepted the monument as a careful and faithful reestablishment of the position of the original corner.
 (1-Sec. 32) Established midway and on the Section line between Section corner 1326.48' West and Quarter corner 1326.48' East.

C. Description of monument for corner and accessories established to perpetuate locating the position of the corner:

(C11) Found 1" ID I. pipe with 4" alum. MDNR cap. Set measuring nails in: 12" W. Birch N19W 15.5' mrkd "S30" * 6" Maple S17W 17.6' mrkd "S31 NBT" 5" Maple N37E 11.6' "S29 NBT" 10" Spruce S89E 29.7' "S32 NBT" Bearings are magnetic. Distances are to nail with tag. * denotes 1974 NBT.	(1) Set 1" IDx36" I. pipe with 4" alum. MDNR cap. Set measuring nails in: 10" Maple S50E 13.9' mrkd "N1/16 BT" 7" Maple S77W 8.0' do 7" Maple S06W 23.65' do 6" Maple N74E 15.35' do Set cedar post adjacent. Bearings are magnetic. Distances are to nail with tag.
---	---

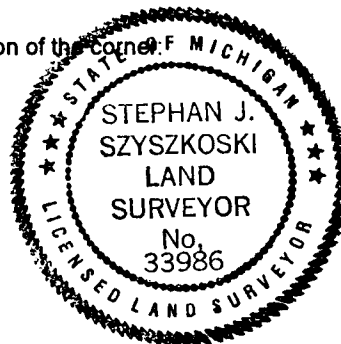

Signed by Stephan J. Szyszkoski
 Surveyor's Michigan License No. 33986

Date 2/9/05