

MICHIGAN  
DEPARTMENT OF CONSERVATION  
FORESTRY DIVISION

LAND CORNER RECORD

T. 48-49N N.R. 8W

Luce COUNTY

DESCRIPTION OF CORNER Sec. Cor. common to Secs. 4-5-32-33

CORNER MONUMENT 1" pipe with 4" aluminum cap.

DATE MONUMENT PLACED AND WITNESSED 8-13-70

WITNESSES TO CORNER..... 8" W. Pine (S5 NBT) S17°W 9.0'

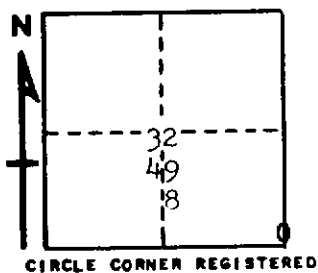

AND

DESCRIPTION IN DETAIL AS TO HOW CORNER WAS LOCATED AND IDENTIFIED OR RESTORED.

Found witnesses, scribed by H. Lawrence, R.L.S. about 1939.  
10" Spruce stub, N80°W 18.1'.  
18" W. Pine N10°W 19.7'.

Placed corner at location, facing the two witnesses, marked by Mr. Lawrence.  
Found no evidence of original witnesses, which were recorded as small spruce.

Corner lies 30' west of a logging road and at the intersection of blazed lines  
in all four directions.

SURVEYOR'S SEAL

SIGNED *Billy D. Buckler*  
Billy D. Buckler  
REGISTERED LAND SURVEYOR

DATE 8-26-70